

[kg] Article n°

Column element RS D30 3.00m	149.0	587909000
Column element RS D30 1.00m	65.0	587908000
Column element RS D30 0.50m	36.0	587907000
Column element RS D30 0.25m	22.5	587944000
Column element RS D35 3.00m	166.0	587912000
Column element RS D35 1.00m	76.0	587911000
Column element RS D35 0.50m	42.0	587910000
Column element RS D35 0.25m	26.0	587945000
Column element RS D40 3.00m	175.0	587915000
Column element RS D40 1.00m	80.7	587914000
Column element RS D40 0.50m	44.9	587913000
Column element RS D40 0.25m	27.7	587946000
Column element RS D45 3.00m	188.0	587918000
Column element RS D45 1.00m	85.0	587917000
Column element RS D45 0.50m	48.0	587916000
Column element RS D45 0.25m	29.0	587947000
Column element RS D50 3.00m	195.0	587921000
Column element RS D50 1.00m	88.0	587920000
Column element RS D50 0.50m	49.0	587919000
Column element RS D50 0.25m	31.5	587948000
Column element RS D60 3.00m	217.0	587927000
Column element RS D60 1.00m	96.5	587926000
Column element RS D60 0.50m	53.0	587925000
Column element RS D60 0.25m	34.2	587950000

Stützelement RS

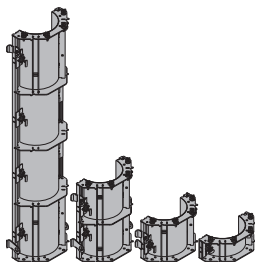

Painted blue

Ø 24 cm, 25 cm, 55 cm, 65 cm,
70 cm, 75 cm and 80 cm on inquiry!**Panel strut 340 without prop head** 24.0 580365000

Elementstütze 340 ohne Stützenkopf

consisting of:

(A) Plumbing strut 340	14.2	588247000
Galvanised		
Length: 190 - 341 cm		
(B) Adjusting strut 120	7.2	588248000
Galvanised		
Length: 80 - 130 cm		
(C) Prop shoe	2.1	588245000
Galvanised		
Length: 20 cm		
Width: 11 cm		
Height: 10 cm		

Galvanised

Delivery condition: folded closed

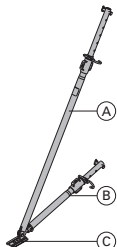
**Panel strut 540 without prop head** 42.2 580366000

Elementstütze 540 ohne Stützenkopf

consisting of:

(A) Plumbing strut 540	29.6	588250000
Galvanised		
Length: 309 - 550 cm		
(B) Adjusting strut 220	10.2	588251000
Length: 171 - 224 cm		
(C) Prop shoe	2.1	588245000
Galvanised		
Length: 20 cm		
Width: 11 cm		
Height: 10 cm		

Galvanised

Delivery condition: folded closed

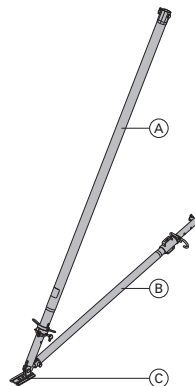
**Panel strut 340** 30.2 588246000

Elementstütze 340

consisting of:

(A) Prop head	3.5	588244000
2 pcs.		
Galvanised		
Length: 40.8 cm		
Width: 11.8 cm		
Height: 17.6 cm		
(B) Prop shoe	2.1	588245000
Galvanised		
Length: 20 cm		
Width: 11 cm		
Height: 10 cm		
(C) Plumbing strut 340	14.2	588247000
Galvanised		
Length: 190 - 341 cm		
(D) Adjusting strut 120	7.2	588248000
Galvanised		
Length: 80 - 130 cm		

Galvanised

Delivery condition: folded closed

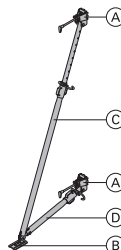

Panel strut 540

Elementstütze 540

consisting of:

(A) Prop head

2 pcs.

Galvanised

Length: 40.8 cm

Width: 11.8 cm

Height: 17.6 cm

(B) Prop shoe

Galvanised

Length: 20 cm

Width: 11 cm

Height: 10 cm

(C) Plumbing strut 540

Galvanised

Length: 309 - 550 cm

(D) Adjusting strut 220

Length: 171 - 224 cm

49.0 588249000**3.5 588244000****2.1 588245000****29.6 588250000****10.2 588251000**

Galvanised

Delivery condition: folded closed

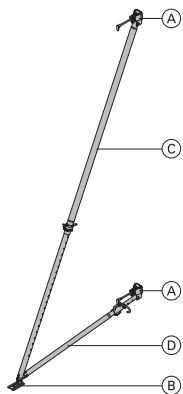
**Eurex 60 550**

Eurex 60 550

depending on length, comprising:

(A) Plumbing strut Eurex 60 550

Powder-coated, blue

Aluminium

Length: 343 - 553 cm

(B) Extension Eurex 60 2.00m

Powder-coated, blue

Aluminium

Length: 250 cm

(C) Coupler Eurex 60

Aluminium

Length: 100 cm

Diameter: 12.8 cm

(D) Connector Eurex 60

Galvanised

Length: 15 cm

Width: 15 cm

Height: 30 cm

(E) Plumbing strut shoe Eurex 60

Galvanised

Length: 31 cm

Width: 12 cm

Height: 33 cm

(F) Adjusting strut 540 Eurex 60

Galvanised

Length: 302 - 543 cm

(G) Prop head

2 pcs.

Galvanised

Length: 40.8 cm

Width: 11.8 cm

Height: 17.6 cm

42.5 582658000**21.3 582651000****8.6 582652000****3.9 582657000****8.5 582660000****29.0 582659000****3.5 588244000**

Delivery condition: separate parts

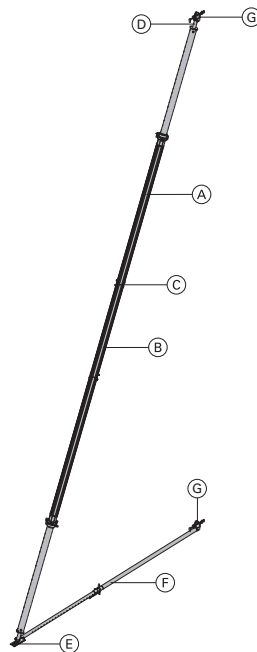
**Universal dismantling tool**

Universal-Lösewerkzeug

3.7 582768000

Galvanised

Length: 75.5 cm

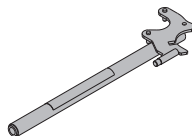

[kg] Article n°

[kg] Article n°

Doka express anchor 16x125mm

Doka-Expressanker 16x125mm

0.31 588631000

Galvanised
Length: 18 cm
Follow fitting instructions!**Screw-set M16x40 DIN 933 8.8**

Schraubensatz M16x40 DIN 933 8.8

0.56 582831000

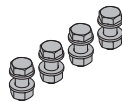
Galvanised
Width-across: 24 mm**Doka coil 16mm**

Doka-Coil 16mm

0.009 588633000

Galvanised
Diameter: 1.6 cm**Multi-purpose waling WS10 Top50 2.50m**

Multi-purpose waling WS10 Top50 2.75m

Multi-purpose waling WS10 Top50 3.00m

Multi-purpose waling WS10 Top50 3.50m

Multi-purpose waling WS10 Top50 4.00m

Multi-purpose waling WS10 Top50 4.50m

Multi-purpose waling WS10 Top50 5.00m

Multi-purpose waling WS10 Top50 5.50m

Multi-purpose waling WS10 Top50 6.00m

Mehrzweckriegel WS10 Top50

48.7 580009000

54.2 580010000

60.2 580011000

68.4 580012000

79.4 580013000

89.1 580014000

102.0 580015000

112.4 580016000

118.0 580017000

Doka column formwork platform 150/90cm

Doka-Stützenbühne 150/90cm

211.8 588382000

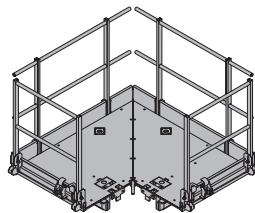
Galvanised
Length: 173 cm
Width: 173 cm
Height: 130 cm
Delivery condition: folded closed

Painted blue

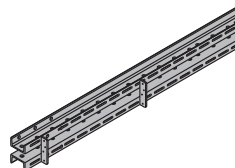
**Platform adapter RS**

Bühnenanschluss RS

17.5 587940000

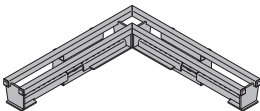
Galvanised
Length: 78 cm
Width: 78 cm
Height: 19 cm**Steel waling WS10 Top50 2.50m**

Steel waling WS10 Top50 3.00m

Steel waling WS10 Top50 3.50m

Steel waling WS10 Top50 4.00m

Steel waling WS10 Top50 4.50m

Steel waling WS10 Top50 5.00m

Steel waling WS10 Top50 5.50m

Steel waling WS10 Top50 6.00m

Stahlwandriegel WS10 Top50

51.0 580046000

60.4 580048000

71.5 580050000

82.1 580052000

92.2 580054000

102.0 580056000

112.4 580058000

122.2 580060000

Painted blue

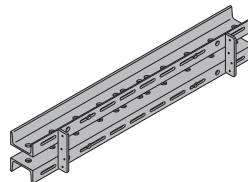
**Bracket connection RS**

Konsolenanschluss RS

5.2 587941000

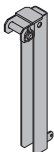
Galvanised
Height: 61 cm**Super plate 15.0**

Superplatte 15,0

1.1 581966000

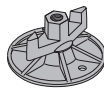
Galvanised
Height: 6 cm
Diameter: 12 mm
Width-across: 27 mm**DIN**
18216**Framax bracket 90**

Framax-Konsole 90

12.5 588167000

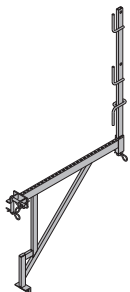
Galvanised
Width: 103 cm
Height: 185 cm
Delivery condition: railing included**Framax universal fixing bolt 10-25cm**

Framax-Universalverbinder 10-25cm

0.69 583002000

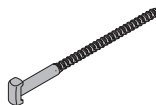
Galvanised
Length: 36 cm**Connecting pin 10cm**

Verbindungsbolzen 10cm

0.34 580201000

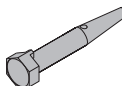
Galvanised
Length: 14 cm**Doka 4-part chain 3.20m**

Doka-Vierstrangkette 3,20m

15.0 588620000

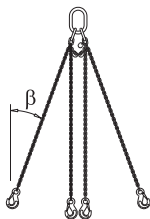

Follow the directions in the "Operating Instructions"!

CE

Spring cotter 5mm

Federvorstecker 5mm

0.05 580204000

Galvanised
Length: 13 cm**Sealing tape KS 20x5mm 10m**

Dichtungsband KS 20x5mm 10m

0.17 580348000

Doka Safety Systems



You will find working and protection platforms, guardrail systems and access systems in the section headed "Doka Safety Systems".