

Doka beam I tec 20 1.80m	10.1	188001000
Doka beam I tec 20 2.45m	13.7	188002000
Doka beam I tec 20 2.65m	14.8	188003000
Doka beam I tec 20 2.90m	16.2	188004000
Doka beam I tec 20 3.30m	18.5	188005000
Doka beam I tec 20 3.60m	20.2	188006000
Doka beam I tec 20 3.90m	21.8	188007000
Doka beam I tec 20 4.50m	25.2	188008000
Doka beam I tec 20 4.90m	27.4	188009000
Doka beam I tec 20 5.35m	30.0	188013000
Doka beam I tec 20 5.90m	33.0	188010000
Doka beam I tec 20m	5.6	188011000

Doka-Träger I tec 20

Varnished yellow

Grey

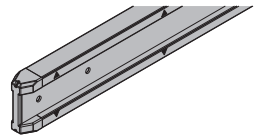

Doka beam I tec 20 12.00m	67.2	188012000
----------------------------------	-------------	------------------

Doka-Träger I tec 20 12,00m

Varnished yellow

Grey

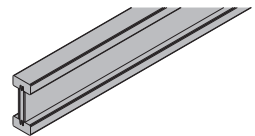

Timber varnish yellow 5l	5.0	176005000
---------------------------------	------------	------------------

Holzlasur gelb 5l