

[kg] Article n°

Dokamatic table 2.50x4.00m 21mm	515.0	586200000
Dokamatic table 2.50x5.00m 21mm	656.0	586201000
Dokamatic table 2.00x4.00m 21mm	480.0	586202000
Dokamatic table 2.00x5.00m 21mm	600.0	586203000

Dokamatic-Tisch

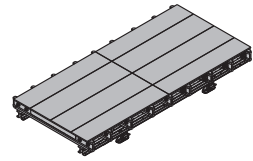

Dokamatic table 2.50x4.00m 27mm	560.0	586204000
Dokamatic table 2.50x5.00m 27mm	685.0	586205000
Dokamatic table 2.00x4.00m 27mm	522.0	586206000
Dokamatic table 2.00x5.00m 27mm	625.0	586207000

Dokamatic-Tisch

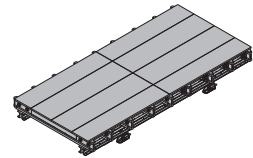

Doka formwork sheet 3-S plus 21mm 9.7/200cm	2.0	186109000
Doka formwork sheet 3-S plus 21mm 9.7/250cm	2.5	186110000
Doka formwork sheet 3-S plus 21mm 20/200cm	4.2	186107000
Doka formwork sheet 3-S plus 21mm 20/250cm	5.3	186108000

Doka-Schalungsplatte 3-S plus 21mm

Doka formwork sheet 3-S plus 27mm 9.7/200cm	2.5	187052000
Doka formwork sheet 3-S plus 27mm 9.7/250cm	3.1	187053000
Doka formwork sheet 3-S plus 27mm 20/200cm	5.2	187050000
Doka formwork sheet 3-S plus 27mm 20/250cm	6.5	187051000

Doka-Schalungsplatte 3-S plus 27mm

Dokamatic table grille 2.50x4.00m	418.0	586208000
Dokamatic table grille 2.50x5.00m	536.0	586209000
Dokamatic table grille 2.00x4.00m	402.0	586210000
Dokamatic table grille 2.00x5.00m	508.0	586211000

Dokamatic-Tischrost

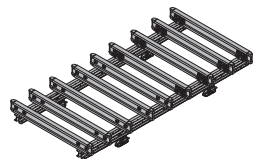

Doka floor prop Eurex 20 top 150 Length: 92 - 150 cm	8.0	586096000
Doka floor prop Eurex 20 top 250 Length: 148 - 250 cm	12.7	586086400
Doka floor prop Eurex 20 top 300 Length: 173 - 300 cm	14.3	586087400
Doka floor prop Eurex 20 top 350 Length: 198 - 350 cm	17.4	586088400
Doka floor prop Eurex 20 top 400 Length: 223 - 400 cm	21.6	586089400
Doka floor prop Eurex 20 top 550 Length: 298 - 550 cm	32.3	586090400
Doka floor prop Eurex 20 top 700 Length: 383 - 700 cm	48.0	586139000

Doka-Deckenstütze Eurex 20 top

Galvanised

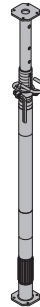

Doka floor prop Eurex 20 250 Length: 152 - 250 cm	12.9	586086000
Doka floor prop Eurex 20 300 Length: 172 - 300 cm	15.3	586087000
Doka floor prop Eurex 20 350 Length: 197 - 350 cm	17.8	586088000
Doka floor prop Eurex 20 400 Length: 227 - 400 cm	22.2	586089000
Doka floor prop Eurex 20 550 Length: 297 - 550 cm	34.6	586090000

Doka-Deckenstütze Eurex 20

Galvanised



	[kg]	Article n°
Doka floor prop Eurex 30 top 250 Length: 148 - 250 cm	12.8	586092400
Doka floor prop Eurex 30 top 300 Length: 173 - 300 cm	16.4	586093400
Doka floor prop Eurex 30 top 350 Length: 198 - 350 cm	20.7	586094400
Doka floor prop Eurex 30 top 400 Length: 223 - 400 cm	24.6	586095400
Doka floor prop Eurex 30 top 450 Length: 248 - 450 cm	29.1	586119400
Doka floor prop Eurex 30 top 550 Length: 303 - 550 cm	38.6	586129000

Doka-Deckenstütze Eurex 30 top

Galvanised



Doka floor prop Eurex 30 250 Length: 152 - 250 cm	14.8	586092000
Doka floor prop Eurex 30 300 Length: 172 - 300 cm	16.7	586093000
Doka floor prop Eurex 30 350 Length: 197 - 350 cm	20.5	586094000
Doka floor prop Eurex 30 400 Length: 227 - 400 cm	24.9	586095000
Doka floor prop Eurex 30 450 Length: 248 - 450 cm	29.2	586119000

Doka-Deckenstütze Eurex 30

Galvanised

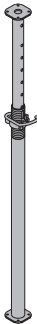

Removable folding tripod 1.20m Stützbein 1,20m	20.7	586145000
--	------	-----------

Galvanised
Height: 120 cm
Delivery condition: folded closed



Dokamatic table waling 12 4.00m	122.5	586212000
Dokamatic table waling 12 5.00m	154.0	586213000

Dokamatic-Tischriegel

Painted blue

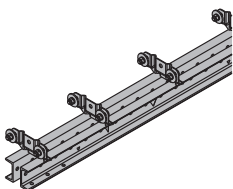

Dokamatic swivel head 40 Dokamatic-Schwenkkopf 40	17.1	586214000
---	------	-----------

Galvanised
Length: 60 cm

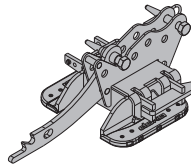

Dokamatic table platform 1.00/2.00m	92.0	586218000
Dokamatic table platform 1.00/2.50m	103.0	586217000

Dokamatic-Tischbühne

Steel parts galvanised
Timber parts varnished yellow
Delivery condition: folded closed

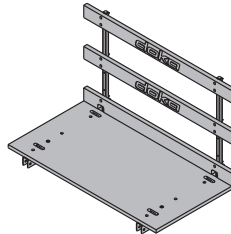

Dokamatic platform bracket 1.00m Dokamatic-Bühnenkonsole 1,00m	19.5	586227000
--	------	-----------

Galvanised
Length: 112 cm
Height: 124 cm

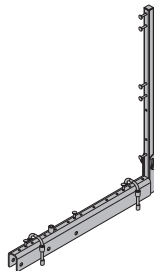

Dokamatic platform extension 0.50/2.00m	31.0	586220000
Dokamatic platform extension 0.50/2.50m	34.3	586219000

Dokamatic-Bühnenverbreiterung

Steel parts galvanised
Timber parts varnished yellow

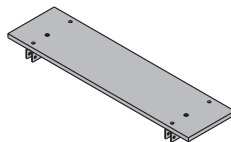

Dokamatic extension profile 0.50m Dokamatic-Verbreiterungsprofil 0,50m	6.0	586228000
--	-----	-----------

Galvanised
Length: 49 cm

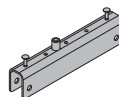

Dokamatic platform profile 1.00m Dokamatic-Bühnenprofil 1,00m	11.0	586221000
---	------	-----------

Galvanised

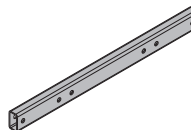

Universal end-shutter support 30cm Universal-Abschalwinkel 30cm	1.0	586232000
---	-----	-----------

Galvanised
Height: 21 cm



Doka floor end-shutter clamp

Doka-Deckenabschalklemme

12.5 586239000

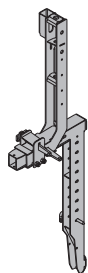
Galvanised
Height: 137 cm**End-shutter shoe**

Abschalschuh

1.6 586257000

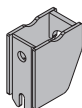
Galvanised
Height: 13.5 cm**End-shutter tie rod 15.0 15-40cm**

Abschalanker 15,0 15-40cm

0.91 586258000

Galvanised
Length: 55 cm**Doka mobile scaffold tower Z**

Doka-Fahrgerüst Z

consisting of:

- | | |
|--|----------------|
| (A) Attachable frame Z 1.00m | 6.7 586016000 |
| (B) Attachable frame Z 2.00m | 11.3 586017000 |
| (C) Railing frame Z 1.00m | 4.1 586021000 |
| (D) Handrail post Z 1.80m | 6.5 586022000 |
| (E) Platform Z with manhole flap 1.80m | 17.5 586023000 |
| (F) Platform Z without manhole flap 1.80m | 17.0 586024000 |
| (G) End toe-board Z 1.35m | 4.0 586025000 |
| (H) Side toe-board Z 1.80m | 5.1 586026000 |
| (I) Diagonal brace Z 2.00m | 3.0 586027000 |
| (J) Horizontal brace Z 1.80m | 2.8 586028000 |
| (K) Triangular bracket Z
(not illustrated) | 5.3 586029000 |
| (L) Guide roller Z D200mm | 7.1 586030000 |
| (M) Step-up rung Z | 2.5 586031000 |
| (N) Platform diagonal strut Z
(not illustrated) | 2.5 586032000 |
| (O) Ballast Z
(not illustrated) | 10.0 586033000 |

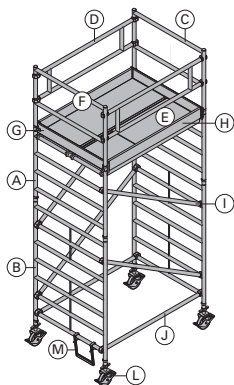
Aluminium
Follow the directions in the "Instructions for assembly and use"!**Dokamatic strut connection**

Dokamatic-Stützenanschluss

1.3 586215000

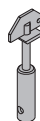
Galvanised
Height: 26 cm**Dokamatic scaffold connection**

Dokamatic-Gerüstanschluss

3.4 586216000

Galvanised
Height: 27 cm**Dokamatic table frame 1.50m**

Dokamatic-Tischrahmen 1,50m

59.8 586224000

Galvanised

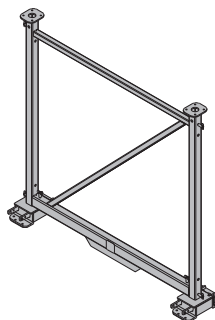
**Diagonal cross 9.150**

5.2 582773000

Diagonal cross 9.200

6.6 582774000

Diagonal cross 9.250

7.7 582775000

Diagonal cross 9.300

9.0 582323000

Diagonal cross 12.150

5.7 582612000

Diagonal cross 12.200

6.9 582614000

Diagonal cross 18.100

6.1 582620000

Diagonalkreuz

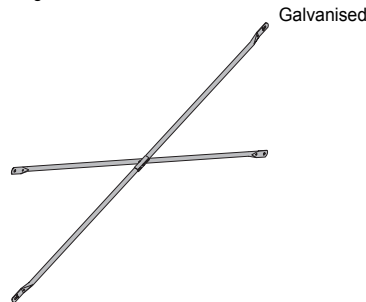
**Dokamatic insertion beam 1.95m**

8.0 183054000

Dokamatic insertion beam 2.45m

10.0 183045000

Dokamatic-Einschubträger

Varnished yellow

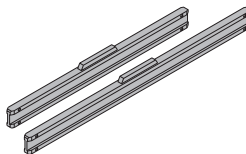
**Supporting head H20 DF**

Haltekopf H20 DF

0.77 586179000

Galvanised
Length: 19 cm
Width: 11 cm
Height: 8 cm

[kg] Article n°

Dokamatic table Staxo spindle connector**3.9 582347000**

Staxo-Spindelanschluss Dokamatic-Tisch

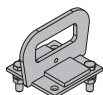
Galvanised
Length: 20.7 cm

[kg] Article n°

Dokamatic floor beam plate 60cm**21.1 586226000**

Dokamatic-Unterzuglasche 60cm

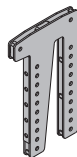
Painted blue
Height: 68 cm**Dokamatic front wood strip 4x8cm 2.60m****4.2 183046000**

Dokamatic-Stirnholz 4x8cm 2,60m

Varnished yellow

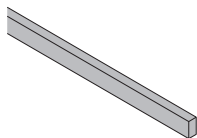
**Dokamatic end-shutter unit 50cm****16.8 586223000**

Dokamatic-Abschaleinheit 50cm

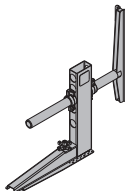
Galvanised
Length: 71 cm
Height: 57 cm**Spring locked connecting pin 16mm****0.25 582528000**

Federbolzen 16mm

Galvanised
Length: 15 cm**Framax universal corner waling****12.8 588151000**

Framax-Eckklemmschiene

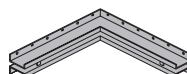
Painted blue
Leg length: 60 cm**T ledge 21/42 2.00m****0.34 580196000**

T-Leiste 21/42 2,00m

Grey

**Dokamatic edge clamp 0.70m****3.9 586222000**

Dokamatic-Randklemme 0,70m

Galvanised

**Adjustable waling extension FF20/50****9.1 587532000**

Ausgleichlasche FF20/50

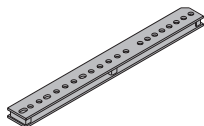
Painted blue
Length: 87 cm**H20 screw-on bracket for formwork sheets****0.19 586256000**

Schalhaut-Schraubwinkel H20

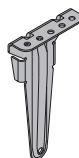
Galvanised
Height: 19.2 cm**Formwork element connector FF20/50 Z****6.0 587533000**

Elementverbinder FF20/50 Z

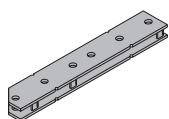
Painted blue
Length: 55 cm**Lashing strap 5.00m****2.8 586018000**

Zurrgurt 5,00m

Yellow

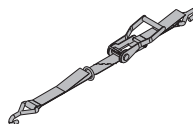
**Beam clamp Top50****1.2 580081000**

Trägerklammer Top50

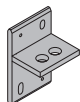
Painted blue
Height: 15 cm**Connecting pin 10cm****0.34 580201000**

Verbindungsbolzen 10cm

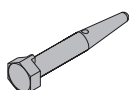
Galvanised
Length: 14 cm**Doka express anchor 16x125mm****0.31 588631000**

Doka-Expressanker 16x125mm

Galvanised
Length: 18 cm
Follow fitting instructions!**Spring cotter 5mm****0.05 580204000**

Federvorstecker 5mm

Galvanised
Length: 13 cm**Doka coil 16mm****0.009 588633000**

Doka-Coil 16mm

Galvanised
Diameter: 1.6 cm

[kg] Article n°

Plumbing strut 340 with prop head

Justierstütze 340 mit Stützenkopf

28.0 580671000

Galvanised
Length: 190 - 341 cm



Plumbing strut 540 with prop head

Justierstütze 540 mit Stützenkopf

35.2 580673000

Galvanised
Length: 309 - 550 cm

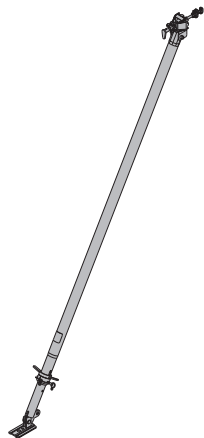

Handrail post T 1.80m

Einschubgeländer T 1,80m

17.7 584373000

Galvanised

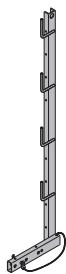

Strip tensioner B 5.00m

Bandzwinde B 5,00m

3.5 580394000

Galvanised

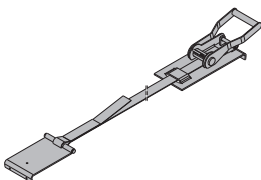

Plastic mallet 4kg

Kunststoffhammer 4kg

4.5 586097000

Blue
Length: 110 cm

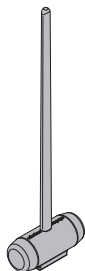

[kg] Article n°

Universal dismantling tool

Universal-Lösewerkzeug

3.7 582768000

Galvanised
Length: 75.5 cm

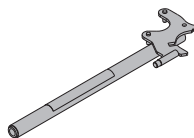

Reversible ratchet 1/2"

Umschaltknarre 1/2"

0.73 580580000

Galvanised
Length: 30 cm

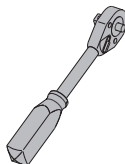

Box nut 30 1/2"

Stecknuss 30 1/2"

0.20 580575000



Shifting appliances for tables



You will find shifting appliances for tables in the section headed "Doka Floor Systems - Shifting appliances for tables".

Doka Safety Systems



You will find working and protection platforms, guardrail systems and access systems in the section headed "Doka Safety Systems".