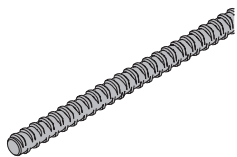

Tie rod system 15.0

| | | |
|-----------------------------------|------|-----------|
| Tie rod 15.0mm galvanised 0.50m | 0.72 | 581821000 |
| Tie rod 15.0mm galvanised 0.75m | 1.1 | 581822000 |
| Tie rod 15.0mm galvanised 1.00m | 1.4 | 581823000 |
| Tie rod 15.0mm galvanised 1.25m | 1.8 | 581826000 |
| Tie rod 15.0mm galvanised 1.50m | 2.2 | 581827000 |
| Tie rod 15.0mm galvanised 1.75m | 2.5 | 581828000 |
| Tie rod 15.0mm galvanised 2.00m | 2.9 | 581829000 |
| Tie rod 15.0mm galvanised 2.50m | 3.6 | 581852000 |
| Tie rod 15.0mm galvanisedm | 1.4 | 581824000 |
| Tie rod 15.0mm non-treated 0.50m | 0.73 | 581870000 |
| Tie rod 15.0mm non-treated 0.75m | 1.1 | 581871000 |
| Tie rod 15.0mm non-treated 1.00m | 1.4 | 581874000 |
| Tie rod 15.0mm non-treated 1.25m | 1.8 | 581886000 |
| Tie rod 15.0mm non-treated 1.50m | 2.1 | 581876000 |
| Tie rod 15.0mm non-treated 1.75m | 2.5 | 581887000 |
| Tie rod 15.0mm non-treated 2.00m | 2.9 | 581875000 |
| Tie rod 15.0mm non-treated 2.50m | 3.6 | 581877000 |
| Tie rod 15.0mm non-treated 3.00m | 4.3 | 581878000 |
| Tie rod 15.0mm non-treated 3.50m | 5.0 | 581888000 |
| Tie rod 15.0mm non-treated 4.00m | 5.7 | 581879000 |
| Tie rod 15.0mm non-treated 5.00m | 7.2 | 581880000 |
| Tie rod 15.0mm non-treated 6.00m | 8.6 | 581881000 |
| Tie rod 15.0mm non-treated 7.50m | 10.7 | 581882000 |
| Tie rod 15.0mm non-treatedm | 1.4 | 581873000 |

Ankerstab 15,0mm

DIN
18216
Wing nut 15.0
Flügelmutter 15,0

0.31 581961000

Galvanised
Length: 10 cm
Height: 5 cm
Width-across: 27 mm
DIN
18216
Super plate 15.0
Superplatte 15,0

1.1 581966000

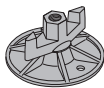
Galvanised
Height: 6 cm
Diameter: 12 cm
Width-across: 27 mm
DIN
18216
Hexagon nut 15.0
Sechskantmutter 15,0

0.23 581964000

Galvanised
Length: 5 cm
Width-across: 30 mm
DIN
18216
Anchor plate 12/12
Ankerplatte 12/12

1.3 581930000

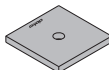

Galvanised

DIN
18216
Anchor plate 15/20
Ankerplatte 15/20

1.8 581929000

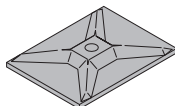

Galvanised

DIN
18216
Angle anchor plate 12/18
Winkelplatte 12/18

1.3 581934000

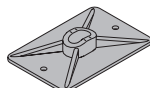

Galvanised

DIN
18216
Fixing plate 15.0
Nagelblech 15,0

0.15 581692000

Galvanised
Diameter: 10 cm**Positioning cone 15.0 5cm**
Vorlaufkonus 15,0 5cm

0.43 581969000

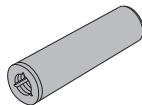
Galvanised
Length: 11 cm
Diameter: 3 cm
Tool: Positioning cone spanner 15.0
DK
Follow fitting instructions!**Climbing cone 15.0 5cm**
Kletterkonus 15,0 5cm

0.97 581980000

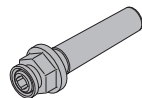
Galvanised
Length: 17 cm
Diameter: 6 cm
Width-across: 41 mm
Follow fitting instructions!**Sealing sleeve 15.0 5cm**
Dichtungshülse 15,0 5cm

0.007 581990000

Black
Length: 10 cm
Diameter: 3 cm**She-bolt 15.0 5cm**
Ankerkopf 15,0 5cm

1.7 581972000

Galvanised
Length: 76 cm
Width-across: 24 mm
Follow fitting instructions!
DIN
18216
She-bolt 15.0 5cm 1.20m
Ankerkopf 15,0 5cm 1,20m

2.5 581832000

Galvanised
Length: 131 cm
Width-across: 24 mm
Follow fitting instructions!
DIN
18216
Cantilever positioning cone 15.0 5cm
Sperrenvorlauf 15,0 5cm

0.45 581699000

Length: 11 cm
Diameter: 5 cm
Tool: Positioning cone spanner 15.0
DK
Follow fitting instructions!**Sealing sleeve S 15.0 5cm**
Dichtungshülse S 15,0 5cm

0.009 581697000

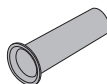
Black
Length: 11 cm
Diameter: 4.7 cm**Fair-faced concrete positioning cone 15.0 5cm**
Sichtbetonvorlauf 15,0 5cm

0.46 581973000

Galvanised
Length: 11 cm
Diameter: 4.3 cm
Tool: Positioning cone spanner 15.0
DK

[kg] Article n°

[kg] Article n°

Suspension cone 15.0 5cm

Aufhängekonus 15,0 5cm

0.88 581971000

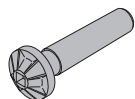

Galvanised
Length: 16 cm
Diameter: 6 cm
Follow fitting instructions!

Positioning disk M30

Vorlaufscheibe M30

0.25 581975000



Galvanised
Diameter: 9 cm

Suspension cone 15.0 f. insulation up to 11cm

Aufhängekonus 15,0 für Isolierung bis 11cm

3.6 580495000

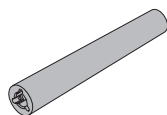

Galvanised
Length: 30 cm
Diameter: 5 cm

Positioning clamp M30

Vorlaufklemme M30

0.19 581833000



Galvanised
Diameter: 4 cm

Sealing sleeve 15.0 f. insulation up to 11cm

Dichtungshülse 15,0 für Isolierung bis 11cm

0.05 580498000

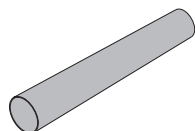

White
Length: 30 cm
Diameter: 6 cm

Screw-in cone 30kN 15.0

Einschraubkonus 30kN 15,0

0.74 581895000

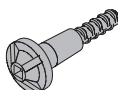

Galvanised
Length: 15 cm

Cone screw RD 28

Konusschraube RD 28

0.65 580496000



Galvanised
Length: 9 cm
Diameter: 6 cm

Bridge edge beam anchor 30kN 15.0

Bridge edge beam anchor 30kN 15.0 galv.

0.45 581896000

Gesimsanker 30kN 15,0

0.44 581890000



Length: 7 cm
Follow fitting instructions!

Positioning disk RD 28

Vorlaufscheibe RD 28

0.25 580497000



Galvanised
Diameter: 9 cm

Nailing cone 15.0

Nagelkonus 15,0

0.02 581897000



Black
Length: 7 cm

Universal climbing cone 15.0

Universal-Kletterkonus 15,0

1.3 581977000

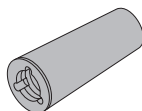

Galvanised
Length: 13 cm
Diameter: 5 cm
Tool: Spanner for universal climbing cone 15.0/20.0

Hole plug 29mm

Gesimsankerstopfen 29mm

0.003 581891000



Grey
Diameter: 3 cm

Cone screw B 7cm

Konusschraube B 7cm

0.86 581444000



red
Length: 10 cm
Diameter: 7 cm
Width-across: 50 mm

Zinc plug 15.0

Zinkstöpsel 15,0

0.20 581889000



Galvanised
Length: 9.9 cm
Diameter: 2.9 cm
Tool: Spanner for 1/2" square head

Sealing sleeve K 15.0

Dichtungshülse K 15,0

0.03 581976000

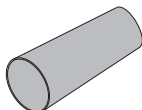

Orange
Length: 12 cm
Diameter: 6 cm

Stop anchor 15.0 11.5cm

Sperranker 15,0 11,5cm

0.77 581868000



Non-treated

Fair-faced concrete positioning cone MF 15.0

Sichtbetonvorlauf MF 15,0

1.5 581928000

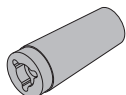

Galvanised
Length: 12.6 cm
Diameter: 5.3 cm
Tool: Spanner for universal climbing cone 15.0/20.0

Stop anchor 15.0 16cm

Sperranker 15,0 16cm

0.83 581997000

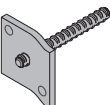

Non-treated

Stop anchor 15.0 40cm

Sperranker 15,0 40cm

1.4 581999000

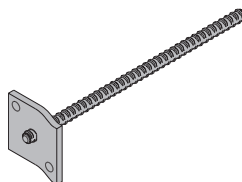

Non-treated

[kg] Article n°

[kg] Article n°

Stop anchor double-ended 15.0 20cm

Sperranker beidseitig 15,0 20cm

1.1 581820000

Water stop G 15.0 33cm

Wassersperre G 15,0 33cm

0.68 581818000

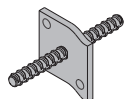

Non-treated

Custom lengths can be ordered under the special-component Art.n° 580100000, quoting the designation and the desired length in mm.

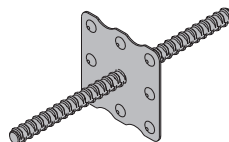

Non-treated

Length: 33 cm

Width: 12 cm

Height: 12 cm

Custom lengths can be ordered under the special-component Art.n° 580100000, quoting the designation and the desired length in mm.

Pigtail anchor 15.0

Wellenanker 15,0

0.92 581984000



Non-treated

Length: 67 cm

Fibre concrete plug 30.7mm

0.03 581902000

Fibre concrete plug 32mm

0.02 581830000

Fibre concrete plug 45mm

0.10 581438000

Fibre concrete plug 54mm

0.16 581955000

Faserbetonstopfen

Grey

Wall anchor 15.0 15cm

Wandanker 15,0 15cm

1.5 581893000

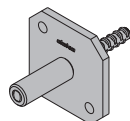

Galvanised

Concrete cone 52mm

0.19 581939000

Betonkonus 52mm

Grey

Suspension cone 15.0 with collar

Bund-Aufhängekonus 15,0

1.4 580428000

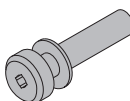

Galvanised

Length: 16 cm

Diameter: 6 cm

Follow fitting instructions!

Rod connector 15.0

Verbindungsmuffe 15,0

0.49 581981000



Non-treated

Length: 11 cm

Diameter: 3 cm

DIN
18216**Rock anchor spreader unit 15.0**

Felsanker-Spreizeinheit 15,0

0.41 581120000

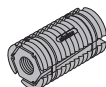

Galvanised

Length: 9 cm

Diameter: 4 cm

Follow fitting instructions!

Weldable coupler 15.0

Anschweißmuffe 15,0

0.25 581691000



Non-treated

Length: 8 cm

Diameter: 3 cm

Safety instruction: Must not be welded with the tie-rod screwed in - risk of rod breakage!

DIN
18216**Rock anchor installation tube**

Felsanker-Einbaurohr

0.85 581123000

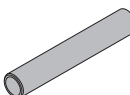

Galvanised

Length: 50 cm

Diameter: 3 cm

Weldable coupler 15.0 for sheet wall

Anschweißmuffe 15,0 für Spundwand

0.75 581693000

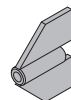

Non-treated

Length: 10 cm

Height: 13 cm

Tensioning instrument B

Vorspanngerät B

34.5 580570000

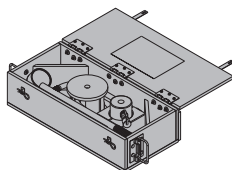

Galvanised

Anchor cone 15.0

Spannkonus 15,0

0.46 581967000



Yellow

Length: 11 cm

Diameter: 6 cm

DIN
18216**Water stop connector 15.0**

Wasserstop 15,0

0.52 581914000

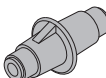

Non-treated

Length: 12 cm

Plastic tube 22mm 2.50m

Kunststoffrohr 22mm 2,50m

0.45 581951000

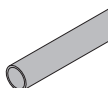
**Water stop 15.0 33cm**

Wassersperre 15,0

1.3 581817000

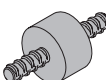

Non-treated

Length: 33 cm

Diameter: 7 cm

Custom lengths can be ordered under the special-component Art.n° 580100000, quoting the designation and the desired length in mm.

Universal cone 22mm

Universal-Konus 22mm

0.005 581995000



Grey

Diameter: 4 cm

[kg] Article n°

[kg] Article n°

Plug 22mm 0.003 581953000

Verschlussstopfen 22mm



Grey

Distance piece 20cm 0.05 581907000

Distance piece 25cm

Distance piece 30cm

Distanzhalter

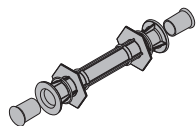

Grey

Fibre concrete tube 22mm 0.18m 0.28 581904000**Fibre concrete tube 22mm 0.23m** 0.36 581905000**Fibre concrete tube 22mm 0.28m** 0.44 581906000**Fibre concrete tube 22mm 0.38m** 0.61 581903000**Fibre concrete tube 22mm 1.25m** 1.9 581991000

Faserbetonrohr 22mm

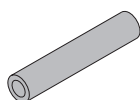
**Fibre concrete plug 22mm** 0.02 581992000

Faserbetonstopfen 22mm

**REPOXAL two component adhesive** 1.2 581993000

REPOXAL-Zweikomponenten Kleber

Form-ply protector for anchor 15.0 0.25 580219000

Schalhautschutz für Anker 15,0



Galvanised

Width-across: 46 mm

Form-ply protector for cone 15.0 0.38 580220000

Schalhautschutz für Konus 15,0

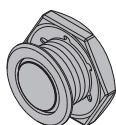

Width-across: 70 mm

Anchor holder 15.0 0.43 581835000

Ankerhalter 15,0

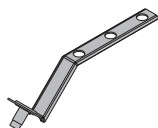

Non-treated

Clearance cone 15.0 0.51 581865000

Freistellkonus 15,0

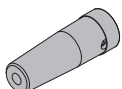

Black

Blue

Length: 20.6 cm

Diameter: 7 cm

Follow fitting instructions!

Clearance-cone dismantling tool 0.67 581864000

Lösewerkzeug Freistellkonus

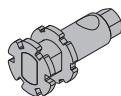

Galvanised

Length: 10.7 cm

Width-across: 24 mm

Positioning cone spanner 15.0 DK 0.30 580579000

Vorlaufschlüssel 15,0 DK



Galvanised

Length: 8 cm

Width-across: 30 mm

Universal cone spanner 15.0/20.0 0.90 581448000

Universal-Konusschlüssel 15,0/20,0



Galvanised

Length: 9 cm

Width-across: 50 mm

Tie rod wrench 15.0/20.0 1.9 580594000

Ankerstabschlüssel 15,0/20,0

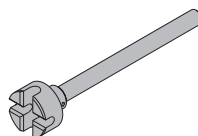

Galvanised

Length: 37 cm

Diameter: 8 cm

Form tie load measuring device 300kN 11.5 581834000

Ankerlastmessgerät 300kN

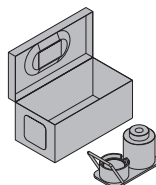

Galvanised

Tie rod system 20.0**Tie rod 20.0mm galvanised 0.50m** 1.3 581411000**Tie rod 20.0mm galvanised 0.75m** 1.9 581417000**Tie rod 20.0mm galvanised 1.00m** 2.5 581412000**Tie rod 20.0mm galvanised 1.25m** 3.2 581418000**Tie rod 20.0mm galvanised 1.50m** 3.8 581413000**Tie rod 20.0mm galvanised 2.00m** 5.0 581414000**Tie rod 20.0mm galvanisedm** 2.5 581410000**Tie rod 20.0mm non-treated 0.50m** 1.3 581405000**Tie rod 20.0mm non-treated 0.75m** 1.9 581416000**Tie rod 20.0mm non-treated 1.00m** 2.5 581406000**Tie rod 20.0mm non-treated 1.50m** 3.8 581407000**Tie rod 20.0mm non-treated 2.00m** 5.0 581408000**Tie rod 20.0mm non-treatedm** 2.5 581403000

Ankerstab 20,0mm

**DIN**
18216**Hexagon nut 20.0** 0.60 581420000

Sechskantmutter 20,0



Galvanised

Length: 7 cm

Width-across: 41 mm

DIN
18216**Anchor plate 20.0 12/12** 1.7 581425000

Ankerplatte 20,0 12/12

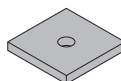

Galvanised

DIN
18216

[kg] Article n°

[kg] Article n°

Super plate 20.0 B

Superplatte 20,0 B

2.0 581424000

Concrete cone 52mm

Betonkonus 52mm

0.19 581939000

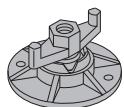
Galvanised
Height: 7 cm
Diameter: 14 cm
Width-across: 34 mm

Grey

She-bolt 20.0

Ankerkopf 20,0

5.6 581435000

Positioning disk M30

Vorlaufscheibe M30

0.25 581975000

Galvanised
Length: 140 cm
Diameter: 5 cm
Width-across: 41 mmGalvanised
Diameter: 9 cm**Anchoring cone 20.0**

Ankerkonus 20,0

1.0 581437000

Positioning clamp M30

Vorlaufklemme M30

0.19 581833000

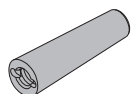
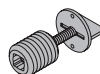
Galvanised
Length: 15 cm
Diameter: 5 cm
Tool: Cone spanner 20.0Galvanised
Diameter: 4 cm**Sealing sleeve 20.0**

Dichtungshülse 20,0

0.03 581441000

Pigtail anchor 20.0

Wellenanker 20,0

2.0 581450000

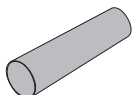
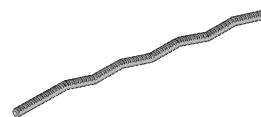
Grey
Length: 16 cm
Diameter: 5 cmNon-treated
Length: 76 cm**Water stop 20.0 33cm**

Wassersperre 20,0 33cm

1.7 581426000

Stop anchor 20.0 22cm

Sperranker 20,0 22cm

1.6 581452000

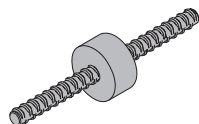
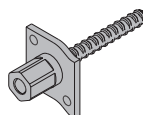
Non-treated
Length: 33 cm
Diameter: 8 cm
Custom lengths can be ordered under the special-component Art.n° 580100000, quoting the designation and the desired length in mm.

Non-treated

Universal climbing cone 20.0

Universal-Kletterkonus 20,0

1.2 581442000

Stop anchor 20.0 45cm

Sperranker 20,0 45cm

2.1 581453000

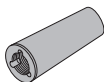
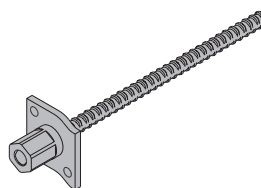
Galvanised
Length: 13 cm
Diameter: 5 cm
Tool: Spanner for universal climbing cone 15.0/20.0

Non-treated

Cone screw B 7cm

Konusschraube B 7cm

0.86 581444000

Plastic tube 26mm 2.00m

Kunststoffrohr 26mm 2,00m

0.59 581463000

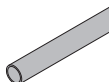
red
Length: 10 cm
Diameter: 7 cm
Width-across: 50 mm**Sealing sleeve K 20.0**

Dichtungshülse K 20,0

0.03 581443000

Universal cone 26mm

Universal-Konus 26mm

0.008 581464000

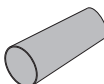
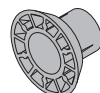
Green
Length: 12 cm
Diameter: 6 cmGrey
Diameter: 5 cm**Fibre concrete plug 35mm**

Faserbetonstopfen

0.11 588923000

Plug 26mm

Verschlussstopfen 26mm

0.006 581465000



Grey



Grey

[kg] Article n°

[kg] Article n°

Cone spanner 20.0

Konusschlüssel 20,0

3.5 581471000

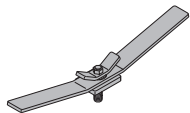
Galvanised
Length: 57 cm**Hexagon nut 26.5**

Sechskantmutter 26,5

0.73 581985000

Galvanised
Length: 8 cm
Width-across: 46 mm**DIN**
18216**Tie rod wrench 15.0/20.0**

Ankerstabschlüssel 15,0/20,0

1.9 580594000

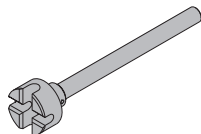
Galvanised
Length: 37 cm
Diameter: 8 cm**Anchor plate 26.5**

Ankerplatte 26,5

3.4 581986000

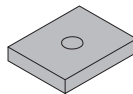
Galvanised
Length: 15 cm
Width: 12 cm**DIN**
18216**Universal cone spanner 15.0/20.0**

Universal-Konusschlüssel 15,0/20,0

0.90 581448000

Galvanised
Length: 9 cm
Width-across: 50 mm**Universal climbing cone 26.5**

Universal-Kletterkonus 26,5

1.1 581987000

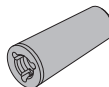
Galvanised
Length: 12.6 cm
Diameter: 5 cm
Tool: Spanner for universal climbing cone 15.0/20.0**Anchor holder 20.0**

Ankerhalter 20,0

0.43 581427000

Non-treated

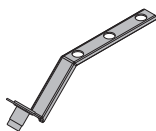
**Cone screw B 7cm**

Konusschraube B 7cm

0.86 581444000

red
Length: 10 cm
Diameter: 7 cm
Width-across: 50 mm**Sealing sleeve K 26.5**

Dichtungshülse K 26,5

0.03 581998000

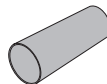
Violet
Length: 12 cm
Diameter: 6 cm**Clearance cone 20.0**

Freistellkonus 20,0

0.49 581866000

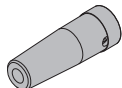
Black
Yellow
Length: 20.6 cm
Diameter: 7 cm
Follow fitting instructions!**Rod connector 26.5**

Verbindungsmuffe 26,5

1.4 581988000

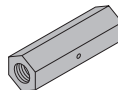
Non-treated
Length: 15 cm
Width-across: 46 mm**DIN**
18216**Clearance-cone dismantling tool**

Lösewerkzeug Freistellkonus

0.67 581864000

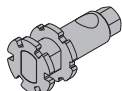
Galvanised
Length: 10.7 cm
Width-across: 24 mm**Pigtail anchor 26.5**

Wellenanker 26,5

3.6 581900000

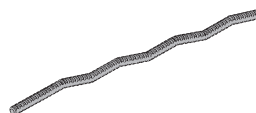
Non-treated
Length: 80 cm**Form tie load measuring device 300kN**

Ankerlastmessgerät 300kN

11.5 581834000

Galvanised

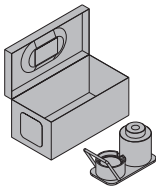
**Plastic tube 32mm 2.00m**

Kunststoffrohr 32mm 2,00m

0.60 581460000

Diameter: 4 cm

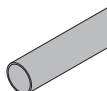
**Tie rod system 26.5****Tie rod 26.5mm non-treatedm**

Ankerstab 26,5mm unbehandeltm

4.5 581883000

DIN
18216**Universal cone 32mm**

Universal-Konus 32mm

0.008 581461000

Grey
Diameter: 5 cm**Universal cone spanner 15.0/20.0**

Universal-Konusschlüssel 15,0/20,0

0.90 581448000

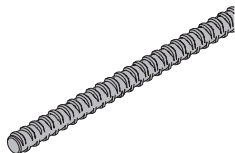
Galvanised
Length: 9 cm
Width-across: 50 mm

[kg] Article n°

[kg] Article n°

Concrete cone 52mm

Betonkonus 52mm

0.19 581939000



Grey

Square spanner 32.0

Vierkantschlüssel 32,0

5.3 582918000

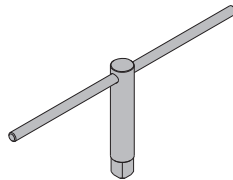

Galvanised
Length: 59 cm

Tie rod wrench 20.0/26.5

Ankerstabschlüssel 20,0/26,5

1.7 580593000

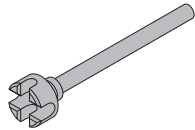

Galvanised
Length: 37 cm
Diameter: 8 cm

Anchor holder 26.5

Ankerhalter 26,5

0.43 581943000

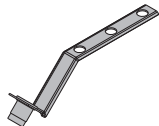

Non-treated

Clearance cone 26.5

Freistellkonus 26,5

0.46 581867000

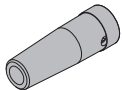

Black
Grey
Length: 20.6 cm
Diameter: 7 cm
Follow fitting instructions!

Clearance-cone dismantling tool

Lösewerkzeug Freistellkonus

0.67 581864000

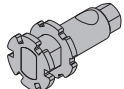

Galvanised
Length: 10.7 cm
Width-across: 24 mm

Tie rod system 32.0

Tie rod 32.0mm non-treatedm

Ankerstab 32,0mm unbehandeltm

6.5 582914000

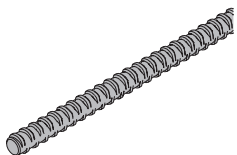

Hexagon nut 32.0

Sechskantmutter 32,0

1.8 582915000



Non-treated
Length: 9 cm
Width-across: 55 mm

Anchor plate 32.0

Ankerplatte 32,0

4.1 582916000

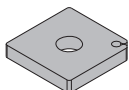

Non-treated
Length: 15 cm
Width: 15 cm

Anchoring cone 32.0

Ankerkonus 32,0

7.7 582917000

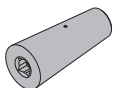

Galvanised
Length: 22.5 cm
Diameter: 10 cm