

[kg] Article n°

Doka folding platform K 3.00m

291.5 580442000

Doka folding platform K 4.50m

444.5 580443000

Doka-Faltbühne K

Timber parts varnished yellow
Steel parts galvanised
Delivery condition: folded closed

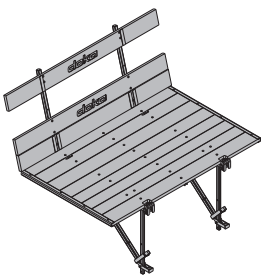
**Screw-on coupler 48mm 50**

0.84 682002000

Anschraubkupplung 48mm 50

Galvanised
Width-across: 22 mm

**Swivel coupler 48mm**

1.5 582560000

Drehkupplung 48mm

Galvanised
Width-across: 22 mm

**Folding bracket K**

52.4 580441000

Faltkonsolle K

Galvanised
Length: 224 cm
Height: 245 cm
Delivery condition: folded closed

**Multi-purpose waling WS10 Top50 3.00m**

60.2 580011000

Multi-purpose waling WS10 Top50 3.50m

68.4 580012000

Multi-purpose waling WS10 Top50 4.00m

79.4 580013000

Mehrzweckriegel WS10 Top50

Painted blue

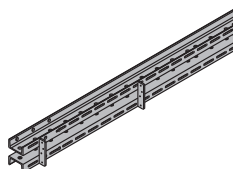
**Connection shoe K**

6.4 580451000

Anschlussschuh K

Galvanised
Length: 25 cm
Width: 17 cm

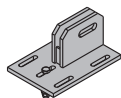
**Steel waling WS10 Top50 3.00m**

60.2 580048000

Steel waling WS10 Top50 3.50m

71.5 580050000

Steel waling WS10 Top50 4.00m

82.1 580052000

Stahlwandriegel WS10 Top50

Painted blue

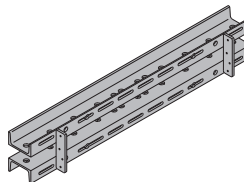
**Suspended platform 120 3.30m**

44.0 580411000

Suspended platform 120 4.30m

52.6 580412000

Hängebühne 120

Galvanised
Delivery condition: folded closed

**Adjusting spindle M36**

6.2 500663002

Höhenjustierspindel M36

Galvanised
Length: 31 cm
Height: 29.2 cm

**Connecting pin 10cm**

0.34 582010000

Verbindungsbolzen 10cm

Galvanised
Length: 14 cm

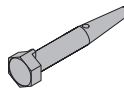
**Spring cotter 5mm**

0.05 582040000

Federvorstecker 5mm

Galvanised
Length: 13 cm

**Scaffold tube 48.3mm 1.00m**

3.6 682014000

Scaffold tube 48.3mm 1.50m

5.4 682015000

Scaffold tube 48.3mm 2.00m

7.2 682016000

Scaffold tube 48.3mm 2.50m

9.0 682017000

Scaffold tube 48.3mm 3.00m

10.8 682018000

Scaffold tube 48.3mm 3.50m

12.6 682019000

Scaffold tube 48.3mm 4.00m

14.4 682021000

Scaffold tube 48.3mm 4.50m

16.2 682022000

Scaffold tube 48.3mm 5.00m

18.0 682023000

Scaffold tube 48.3mm 5.50m

19.8 682024000

Scaffold tube 48.3mm 6.00m

21.6 682025000

Scaffold tube 48.3mmm

3.6 682001000

Gerüstrohr 48,3mm

Galvanised

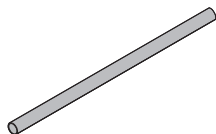
**Waling-to-bracket holder 9-15cm**

2.7 580625000

Riegelhalter 9-15cm

Galvanised

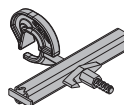

[kg] Article n°

[kg] Article n°

Waling-to-bracket holder

Keilriegelhalter

2.5 580526000

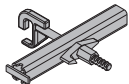
Galvanised
Length: 26 cm
Height: 31 cm**Pin D16/112**

Steckbolzen D16/112

0.29 500403300

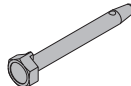
Galvanised
Length: 16 cm**Framax wedge clamp**

Framax-Spannklemme

1.5 588152000

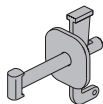
Galvanised
Length: 21 cm**Top scaffold bracket L**

Betonierkonsole L

12.6 587153500

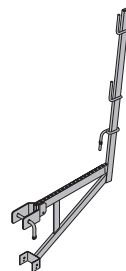
Galvanised
Length: 101 cm
Height: 159 cm**Panel strut 340**

Elementstütze 340

consisting of:

(A) Prop head

2 pcs.

Galvanised
Length: 40.8 cm
Width: 11.8 cm
Height: 17.6 cm

30.2 588246000

3.5 588244000

(B) Prop shoeGalvanised
Length: 20 cm
Width: 11 cm
Height: 10 cm

2.1 588245000

(C) Plumbing strut 340Galvanised
Length: 190 - 341 cm

14.2 588247000

(D) Adjusting strut 120Galvanised
Length: 80 - 130 cm

7.2 588248000

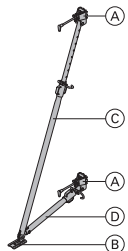
Galvanised
Delivery condition: folded closed**Top scaffold bracket L painted**

Betonierkonsole L lackiert

12.0 587153000

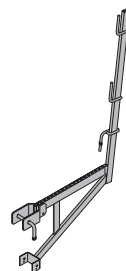
Painted blue
Length: 101 cm
Height: 159 cm**Universal bracket 90**

Universal-Konsole 90

30.4 580476000

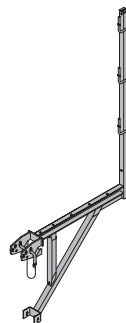
Galvanised
Length: 121 cm
Height: 235 cm**Universal dismantling tool**

Universal-Lösewerkzeug

3.7 582768000

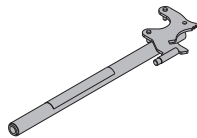
Galvanised
Length: 75.5 cm**Star screw**

Sternschraube

0.75 580425000

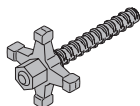
Galvanised
Length: 17 cm**Wind bracing MF/150F/K 6.00m**

Windabspannung MF/150F/K 6,00m

4.7 580665000

Galvanised

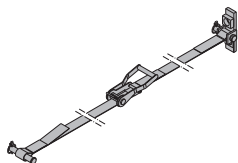
**Framax bracket 90**

Framax-Konsole 90

12.5 588167000

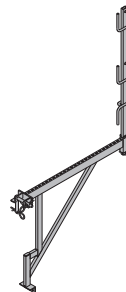
Galvanised
Width: 103 cm
Height: 185 cm
Delivery condition: railing included**Universal railing shackle**

Universal-Geländerbügel

3.0 580478000

Galvanised
Height: 20 cm

[kg] Article n°

Scaffold tube connection

Gerüstrohranschluss

0.27 584375000

Galvanised
Height: 7 cm**Doka 4-part chain 3.20m**

Doka-Vierstrangkette 3,20m

15.0 588620000

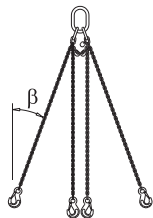

Follow the directions in the "Operating Instructions"!

**Fix-De-Fix remote uncoupling system 3150kg**

Abhängeautomat Fix-De-Fix 3150kg

27.0 586014000

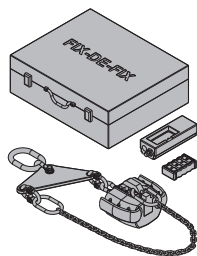

Follow the directions in the "Operating Instructions"!

**Warning sign "No entry" 300x300mm**

Verbotsschild "Zutritt Verboten" 300x300mm

0.70 581575000

**Universal tool box 15.0**Universal-Werkzeugbox 15,0
included in scope of supply:

9.1 580392000

(A) Reversible ratchet 1/2"Galvanised
Length: 30 cm

0.73 580580000

(B) Fork wrench 13/17

0.08 580577000

(C) Fork wrench 22/24

0.22 580587000

(D) Fork wrench 30/32

0.80 580897000

(E) Fork wrench 36/41

1.0 580586000

(F) Ring spanner 17/19

0.27 580590000

(G) Square nut 22

0.31 580589000

(H) Box spanner 41

0.99 580585000

(I) Extension 11cm 1/2"

0.20 580581000

(J) Extension 22cm 1/2"

0.31 580582000

(K) Universal joint coupling

0.16 580583000

(L) Nut for box spanner 19 1/2" L

0.16 580598000

(M) Box nut 13 1/2"

0.06 580576000

(N) Box nut 24 1/2"

0.12 580584000

(O) Box nut 30 1/2"

0.20 580575000

(P) Positioning cone spanner 15.0 DK

0.30 580579000

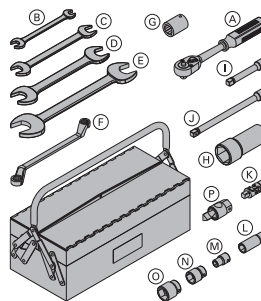
Galvanised
Length: 8 cm
Width-across: 30 mm**Doka Safety Systems**

You will find working and protection platforms, guardrail systems and access systems in the section headed "Doka Safety Systems".