

	[kg]	Article n°
Circular formwork element H20 2.40x0.70m	195.0	587820000
Circular formwork element H20 2.40x1.20m	244.0	587821000
Circular formwork element H20 2.40x2.40m	472.0	587822000
Circular formwork element H20 2.40x3.00m	523.0	587813000
Circular formwork element H20 2.40x3.60m	699.0	587823000
Rundschalungselement H20 2,40m		

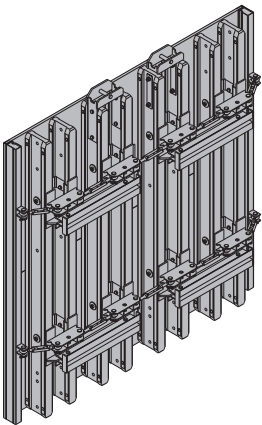

Circular formwork element H20 2.50x0.70m	197.0	587825000
Circular formwork element H20 2.50x1.20m	249.0	587826000
Circular formwork element H20 2.50x2.40m	480.0	587827000
Circular formwork element H20 2.50x3.00m	534.0	587814000
Circular formwork element H20 2.50x3.60m	716.0	587828000
Rundschalungselement H20 2,50m		

Stacking plate for circular formwork H20	7.0	587830000
Aufstockklasche für Rundschalung H20		



Galvanised
Height: 62 cm

Adjustable clamp 10cm	3.7	587808000
Ausgleichsspanner 10cm		

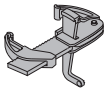

Galvanised
Length: 30 cm

Framax stop-end tie	1.5	588143000
Framax-Stirnanker		

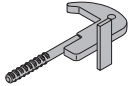

Galvanised
Length: 29 cm

Framax multi function clamp	5.8	588169000
Framax-Uni-Spanner		

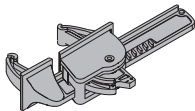

Galvanised
Length: 40 cm

Wrench for circular formwork H20	0.70	587807000
Schlüssel für Rundschalung H20		

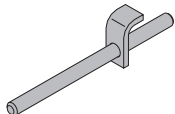

Galvanised
Length: 27 cm

	[kg]	Article n°
Template f. circular formw. H20/.....mm	6.5	177020000
Schablone für Rundschalung H20/.....mm		
Weight per m ²		
Project-specific!		

Panel strut 340 without prop head	24.0	580365000
--	-------------	------------------

Elementstütze 340 ohne Stützenkopf

consisting of:

(A) Plumbing strut 340	14.2	588247000
-------------------------------	-------------	------------------

Galvanised
Length: 190 - 341 cm

(B) Adjusting strut 120	7.2	588248000
--------------------------------	------------	------------------

Galvanised
Length: 80 - 130 cm

(C) Prop shoe	2.1	588245000
----------------------	------------	------------------

Galvanised
Length: 20 cm
Width: 11 cm
Height: 10 cm

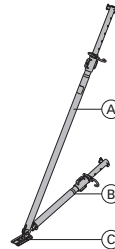

Galvanised
Delivery condition: folded closed

Panel strut 540 without prop head	42.2	580366000
--	-------------	------------------

Elementstütze 540 ohne Stützenkopf

consisting of:

(A) Plumbing strut 540	29.6	588250000
-------------------------------	-------------	------------------

Galvanised
Length: 309 - 550 cm

(B) Adjusting strut 220	10.2	588251000
--------------------------------	-------------	------------------

Length: 171 - 224 cm

(C) Prop shoe	2.1	588245000
----------------------	------------	------------------

Galvanised
Length: 20 cm
Width: 11 cm
Height: 10 cm

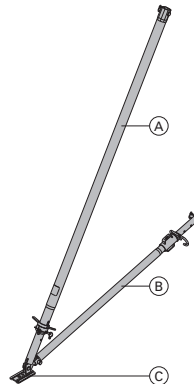

Galvanised
Delivery condition: folded closed

Panel strut 340 Elementstütze 340 consisting of:	30.2 588246000	Eurex 60 550 Eurex 60 550 depending on length, comprising:	
(A) Prop head 2 pcs. Galvanised Length: 40.8 cm Width: 11.8 cm Height: 17.6 cm	3.5 588244000	(A) Plumbing strut Eurex 60 550 Powder-coated, blue Aluminium Length: 343 - 553 cm	42.5 582658000
(B) Prop shoe Galvanised Length: 20 cm Width: 11 cm Height: 10 cm	2.1 588245000	(B) Extension Eurex 60 2.00m Powder-coated, blue Aluminium Length: 250 cm	21.3 582651000
(C) Plumbing strut 340 Galvanised Length: 190 - 341 cm	14.2 588247000	(C) Coupler Eurex 60 Aluminium Length: 100 cm Diameter: 12.8 cm	8.6 582652000
(D) Adjusting strut 120 Galvanised Length: 80 - 130 cm	7.2 588248000	(D) Connector Eurex 60 Galvanised Length: 15 cm Width: 15 cm Height: 30 cm	3.9 582657000
		(E) Plumbing strut shoe Eurex 60 Galvanised Length: 31 cm Width: 12 cm Height: 33 cm	8.5 582660000
		(F) Adjusting strut 540 Eurex 60 Galvanised Length: 302 - 543 cm	29.0 582659000
		(G) Fixing unit RD Galvanised Length: 19 cm Width: 8 cm	1.9 587806000
		(H) Bolt for prop head D25 110	0.45 508244050
		(I) Linch pin 6x40 galv. DIN 11023	0.03 020401
		Delivery condition: separate parts	

Galvanised
Delivery condition: folded closed

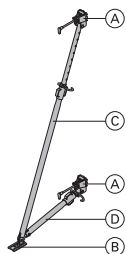

Panel strut 540 Elementstütze 540 consisting of:	49.0 588249000		
(A) Prop head 2 pcs. Galvanised Length: 40.8 cm Width: 11.8 cm Height: 17.6 cm	3.5 588244000		
(B) Prop shoe Galvanised Length: 20 cm Width: 11 cm Height: 10 cm	2.1 588245000		
(C) Plumbing strut 540 Galvanised Length: 309 - 550 cm	29.6 588250000		
(D) Adjusting strut 220 Length: 171 - 224 cm	10.2 588251000		

Galvanised
Delivery condition: folded closed

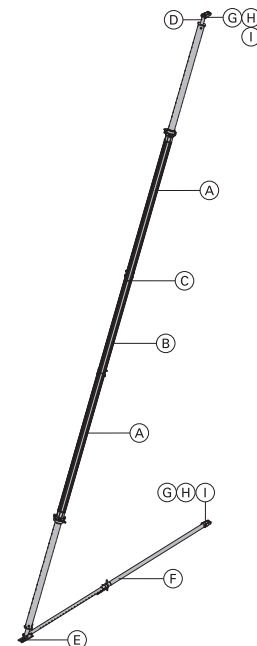
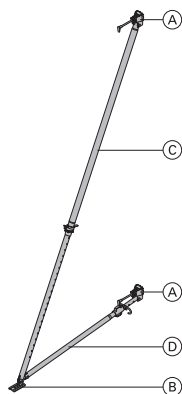

Fixing unit RD Befestigungseinheit RD	1.9 587806000	Universal dismantling tool Universal-Lösewerkzeug	3.7 582768000
		Galvanised Length: 75.5 cm	



Galvanised
Length: 19 cm
Width: 8 cm

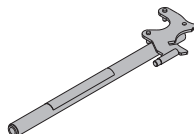

[kg] Article n°

Doka express anchor 16x125mm

Doka-Expressanker 16x125mm

0.31 588631000



Galvanised
Length: 18 cm
Follow fitting instructions!

Doka coil 16mm

Doka-Coil 16mm

0.009 588633000



Galvanised
Diameter: 1.6 cm

Universal bracket 90

Universal-Konsole 90

30.4 580476000

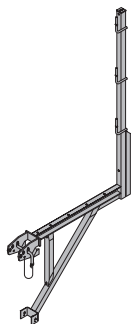

Galvanised
Length: 121 cm
Height: 235 cm

Top scaffold bracket L

Betonierkonsole L

12.6 587153500

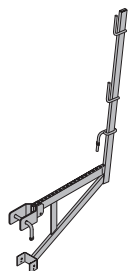

Galvanised
Length: 101 cm
Height: 159 cm

Top scaffold bracket L painted

Betonierkonsole L lackiert

12.0 587153000

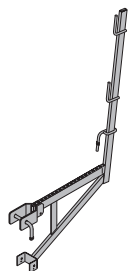

Painted blue
Length: 101 cm
Height: 159 cm

Scaffold tube 48.3mm 1.00m

3.6 682014000

Scaffold tube 48.3mm 1.50m

5.4 682015000

Scaffold tube 48.3mm 2.00m

7.2 682016000

Scaffold tube 48.3mm 2.50m

9.0 682017000

Scaffold tube 48.3mm 3.00m

10.8 682018000

Scaffold tube 48.3mm 3.50m

12.6 682019000

Scaffold tube 48.3mm 4.00m

14.4 682021000

Scaffold tube 48.3mm 4.50m

16.2 682022000

Scaffold tube 48.3mm 5.00m

18.0 682023000

Scaffold tube 48.3mm 5.50m

19.8 682024000

Scaffold tube 48.3mm 6.00m

21.6 682025000

Scaffold tube 48.3mmm

3.6 682001000

Gerüstrohr 48,3mm

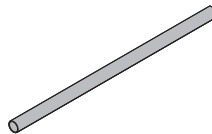

Galvanised

Scaffold tube connection

Gerüstrohranschluss

0.27 584375000



Galvanised
Height: 7 cm

Screw-on coupler 48mm 50

Anschraubkupplung 48mm 50

0.84 682002000



Galvanised
Width-across: 22 mm

Doka 4-part chain 3.20m

Doka-Vierstrangkette 3,20m

15.0 588620000

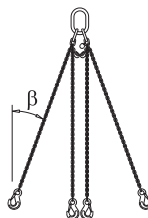

Follow the directions in the "Operating Instructions"!

CE

Fix-De-Fix remote uncoupling system 3150kg

Abhängeautomat Fix-De-Fix 3150kg

27.0 586014000

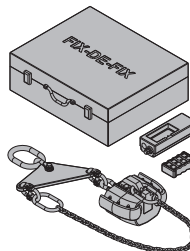

Follow the directions in the "Operating Instructions"!

CE



Framax fitting timber 2x12cm 2.70m

3.1 176020000

Framax fitting timber 3x12cm 2.70m

4.7 176022000

Framax fitting timber 5x12cm 2.70m

7.8 176024000

Framax fitting timber 10x12cm 2.70m

15.5 176026000

Framax-Passholz 2,70m

Varnished yellow



Reversible ratchet 1/2"

Umschaltknarre 1/2"

0.73 580580000

Galvanised
Length: 30 cm

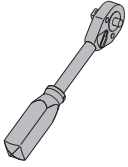

Box nut 24 1/2"

Stecknuss 24 1/2"

0.12 580584000



Doka Safety Systems



You will find working and protection platforms, guardrail systems and access systems in the section headed "Doka Safety Systems".