

Staxo 100 frame 1.80m
 Staxo 100 frame 1.20m
 Staxo 100 frame 0.90m
 Staxo 100-Rahmen

Galvanised

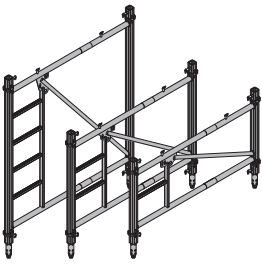

[kg] Article n°
 37.0 582300000
 28.0 582301000
 24.0 582302000

Diagonal cross 9.060
 Diagonal cross 9.100
 Diagonal cross 9.150
 Diagonal cross 9.165
 Diagonal cross 9.175
 Diagonal cross 9.200
 Diagonal cross 9.250
 Diagonal cross 9.300
 Diagonal cross 12.060
 Diagonal cross 12.100
 Diagonal cross 12.150
 Diagonal cross 12.165
 Diagonal cross 12.175
 Diagonal cross 12.200
 Diagonal cross 12.250
 Diagonal cross 12.300
 Diagonal cross 18.100
 Diagonal cross 18.150
 Diagonal cross 18.165
 Diagonal cross 18.175
 Diagonal cross 18.200
 Diagonal cross 18.250
 Diagonal cross 18.300

3.1 582322000
 4.1 582772000
 5.2 582773000
 5.7 582627000
 6.1 582334000
 6.6 582774000
 7.7 582775000
 9.0 582323000
 4.2 582324000
 4.6 582610000
 5.7 582612000
 6.1 582628000
 6.3 582335000
 6.9 582614000
 8.3 582616000
 9.3 582325000
 6.1 582620000
 6.9 582622000
 7.3 582629000
 7.8 582336000
 7.8 582624000
 9.1 582626000
 10.3 582326000

Diagonalkreuz

Galvanised
 Delivery condition: folded closed



Diagonal cross H 9.100
 Diagonal cross H 9.150
 Diagonal cross H 9.200
 Diagonal cross H 9.250
 Diagonal cross H 12.100
 Diagonal cross H 12.150
 Diagonal cross H 12.200
 Diagonal cross H 12.250

5.7 582337000
 7.2 582338000
 9.3 582339000
 11.3 582340000
 5.8 582341000
 7.5 582342000
 9.3 582343000
 10.5 582344000

Diagonalkreuz H

Galvanised
 Delivery condition: folded closed

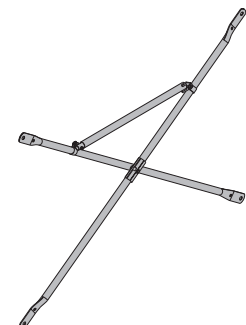

U-head D
 Gabelkopf D

[kg] Article n°
 6.7 582709000

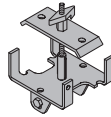

Galvanised
 Length: 20 cm
 Width: 22 cm
 Height: 37 cm

4-way screw-jack head
 Vierwegkopfspindel

10.4 582638000

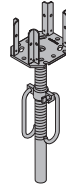

Galvanised
 Height: 86 cm

Screw jack U-head
 Kopfspindel

9.2 582636000



Galvanised
 Height: 74 cm

Heavy duty screw jack 70 top
 Lastspindel 70 oben

9.2 582327000

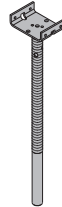

Height: 106 cm

Split nut B
 Spannmutter B

2.0 582634000

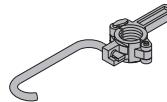

Galvanised

Clamping plate for U-head
 Klemmplatte für Gabelkopf

2.0 502709030



Galvanised
 Length: 24 cm
 Width: 9 cm

Wing nut 15.0
 Flügelmutter 15,0

0.31 581961000



Galvanised
 Length: 10 cm
 Height: 5 cm
 Width-across: 27 mm



Locking rod 15.0 330mm
 Quetschteil 15,0

0.48 582641000

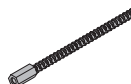

Galvanised
 Width-across: 24 mm

Dokamatic table Staxo spindle connector

Staxo-Spindelanschluss Dokamatic-Tisch

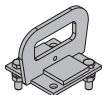
3.9 582347000Galvanised
Length: 20.7 cm**Staxo 100 single leg 1.80m****Staxo 100 single leg 1.20m****Staxo 100 single leg 0.90m**

Staxo 100-Einzelstiel

24.0 582303000**21.5 582304000****20.2 582305000**

Galvanised

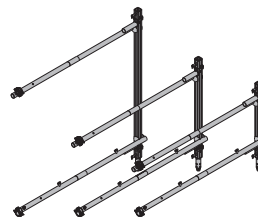
**Wedge for screw jack %**

Spindelkeil %

0.46 176071000Length: 20 cm
Width: 16 cm**Staxo wedge support WS10**

Staxo-Keilaufleger WS10

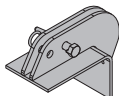
8.7 582796000Galvanised
Length: 31 cm
Width: 15 cm
Height: 23 cm**Doka floor prop Eurex 60 550**

Doka-Deckenstütze Eurex 60 550

47.0 582650000Aluminium
Length: 345 - 555 cm**Swivel bearing plate for screw jack U-head**

Gelenkaufsatz Kopfspindel

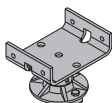
5.2 582799000Galvanised
Length: 20.8 cm
Width: 15.0 cm
Height: 14.4 cm**Screw jack foot**

Fußspindel

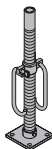
9.0 582637000Galvanised
Height: 69 cm**Heavy duty screw jack 70**

Lastspindel 70

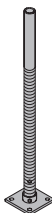
8.8 582639000Galvanised
Height: 101 cm**Extension Eurex 60 2.00m**

Verlängerung Eurex 60 2,00m

21.3 582651000Powder-coated, blue
Aluminium
Length: 250 cm**Heavy duty screw jack 130**

Lastspindel 130

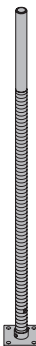
13.0 582711000Galvanised
Height: 173 cm**Coupler Eurex 60**

Kupplungsstück Eurex 60

8.6 582652000Aluminium
Length: 100 cm
Diameter: 12.8 cm**U-head Eurex 60**

Gabelkopf Eurex 60

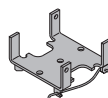
2.9 582656000Galvanised
Length: 22 cm
Width: 20 cm
Height: 12 cm

[kg] Article n°

[kg] Article n°

4-way head Eurex 60

Vierwegkopf Eurex 60

4.5 582655000

Galvanised
Length: 25 cm
Width: 21 cm
Height: 21 cm

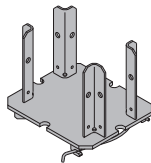

Plumbing strut Eurex 60 550

Justierstütze Eurex 60 550

42.5 582658000

Powder-coated, blue
Aluminium
Length: 343 - 553 cm



Prop head Eurex 60 Top50

Stützenkopf Eurex 60 Top50

7.1 582665000

Galvanised
Height: 50 cm



Connector Eurex 60

Verbindungsstück Eurex 60

3.9 582657000

Galvanised
Length: 15 cm
Width: 15 cm
Height: 30 cm



Plumbing strut shoe Eurex 60

Justierstützenfuß Eurex 60

8.5 582660000

Galvanised
Length: 31 cm
Width: 12 cm
Height: 33 cm

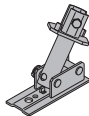

Swivel coupler 48mm Eurex 60

Drehkupplung 48mm Eurex 60

1.0 582654000

Galvanised
Width-across: 22 mm

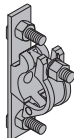

Plumbing strut 340 for precast members

Justierstütze 340 für Fertigteile

18.2 588296000

Galvanised
Length: 190 - 341 cm



Plumbing strut 540 for precast members

Justierstütze 540 für Fertigteile

33.3 588297000

Galvanised
Length: 309 - 550 cm

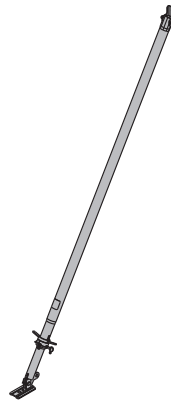

Universal dismantling tool

Universal-Lösewerkzeug

3.7 582768000

Galvanised
Length: 75.5 cm

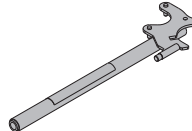

Removable folding tripod 1.20m

Stützbein 1,20m

20.7 586145000

Galvanised
Height: 120 cm
Delivery condition: folded closed



Doka express anchor 16x125mm

Doka-Expressanker 16x125mm

0.31 588631000

Galvanised
Length: 18 cm
Follow fitting instructions!



Doka coil 16mm

Doka-Coil 16mm

0.009 588633000

Galvanised
Diameter: 1.6 cm



[kg] Article n°

Scaffold planking 60/60cm	6.1	582330500
Scaffold planking 60/100cm	9.5	582306500
Scaffold planking 60/150cm	13.6	582307500
Scaffold planking 60/175cm	15.5	582332500
Scaffold planking 60/200cm	17.8	582308500
Scaffold planking 60/250cm	22.2	582309500
Scaffold planking 60/300cm	26.2	582310500
Gerüstbelag		

Aluminium

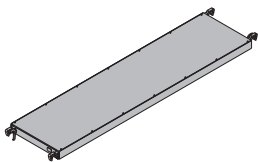

Scaffold planking 60/100cm with manhole	9.5	582311500
Scaffold planking 60/150cm with manhole	13.8	582312500
Scaffold planking 60/175cm with manhole	15.5	582333500
Scaffold planking 60/200cm with manhole	17.7	582313500
Scaffold planking 60/250cm with manhole	20.8	582314500
Scaffold planking 60/300cm with manhole	26.3	582315500
Gerüstbelag mit Durchstieg		

Aluminium

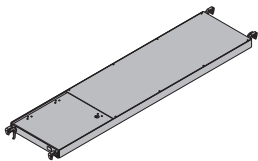

Staxo 100 toeboard	5.5	582329000
Staxo 100-Fußwehr		

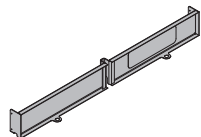
Galvanised
Length: 131 cm
Height: 15 cm

Staxo 100 planking strut 1.00m	6.1	582348000
Staxo 100 planking strut 1.50m	9.0	582349000
Staxo 100-Belagstrebe		

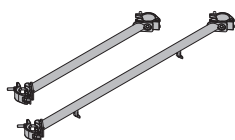
Galvanised
Width-across: 22 mm

Staxo front railing	10.5	582316000
Staxo-Stimgeländer		

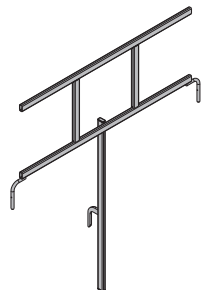
Galvanised
Length: 140 cm
Height: 152 cm

Staxo side railing 100	17.0	582317500
Staxo side railing 150	20.0	582318500
Staxo side railing 175	22.4	582331500
Staxo side railing 200	24.3	582319500
Staxo side railing 250	28.2	582320500
Staxo side railing 300	31.4	582321500
Staxo-Seitengeländer		

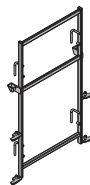
Galvanised
Height: 152 cm

Spring locked connecting pin 16mm	0.25	582528000
Federbolzen 16mm		

Galvanised
Length: 15 cm

Scaffold tube 48.3mm 1.00m	3.6	682014000
Scaffold tube 48.3mm 1.50m	5.4	682015000
Scaffold tube 48.3mm 2.00m	7.2	682016000
Scaffold tube 48.3mm 2.50m	9.0	682017000
Scaffold tube 48.3mm 3.00m	10.8	682018000
Scaffold tube 48.3mm 3.50m	12.6	682019000
Scaffold tube 48.3mm 4.00m	14.4	682021000
Scaffold tube 48.3mm 4.50m	16.2	682022000
Scaffold tube 48.3mm 5.00m	18.0	682023000
Scaffold tube 48.3mm 5.50m	19.8	682024000
Scaffold tube 48.3mm 6.00m	21.6	682025000
Scaffold tube 48.3mmm	3.6	682001000
Gerüströhr 48,3mm		

Galvanised

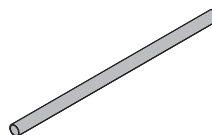

Transition swivel coupler 48/76mm	1.9	582563000
Übergangsdrehkupplung 48/76mm		

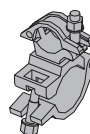
Galvanised
Width-across: 22 mm

Swivel coupler 48mm	1.5	582560000
Drehkupplung 48mm		

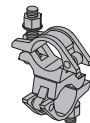
Galvanised
Width-across: 22 mm

Normal coupler 48mm	1.2	682004000
Normalkupplung 48mm		

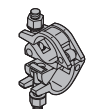
Galvanised
Width-across: 22 mm

Pin coupling 60mm	1.0	582546000
Zapfenkupplung 60mm		

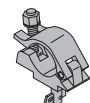
Galvanised
Width-across: 22 mm

[kg] Article n°

[kg] Article n°

Brace stirrup 8

Spannbügel 8

2.7 582751000

Galvanised
Width: 19 cm
Height: 46 cm
Width-across: 30 mm

Rafter plate right

Sparrenpfettenanker

0.09 582521000**0.09 582522000**

Galvanised
Length: 17 cm

Handrail post 1.50m

Geländer 1,50m

12.4 582754000

Galvanised

Handrail post T 1.80m

Einschubgeländer T 1,80m

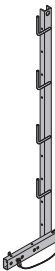
17.7 584373000

Galvanised

Scaffold tube connection

Gerüstrohranschluss

0.27 584375000

Galvanised
Height: 7 cm

Lifting rod 15.0

Umsetzstab 15,0

1.9 586074000

Painted blue
Height: 57 cm
Follow the directions in the "Operating Instructions"!

CE

Retaining plate 15.0

Jochplatte 15,0

1.8 586073000

Galvanised
Length: 17 cm
Width: 12 cm
Height: 11 cm

Bracing for load-bearing towers

Abspannung für Traggerüste

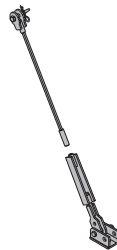
11.6 582795000

Galvanised
Painted blue

Bracing waling connector WS10

Abspann-Riegelverbinder WS10

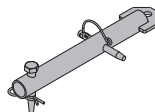
2.7 582756000

Galvanised
Length: 46.7 cm

Spindle connecting plate T

Spindellasche T

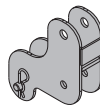
3.1 584371000

Galvanised
Width: 20 cm
Height: 25 cm

Universal plug R20/25

Kombi Ankerstopfen R20/25

0.003 588180000

Blue
Diameter: 3 cm

Staxo 100 mounting gallows 40kg

Staxo 100-Montagegalgen 40kg

7.5 582328000

Galvanised
Height: 258 cm
Follow the directions in the "Operating Instructions"!

CE

Staxo 100 hoisting cable 40kg 30m

Staxo 100-Aufzugsseil 40kg 30m

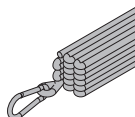
1.3 582346000**Staxo 100 attaching cable 40cm**

Staxo 100-Anschlagseil 40cm

0.31 582345000

CE

[kg] Article n°

[kg] Article n°

Winch 70
Zahnstangenwinde 70

31.0 582779000

Painted blue
Height: 126 cm
Follow the directions in the "Operating Instructions"!

CE

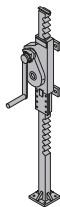
**Shifting carriage TG**
Hubwagen TG

168.0 582778000

Galvanised
Length: 99 cm
Width: 152 cm
Height: 148 cm
Follow the directions in the "Operating Instructions"!

CE

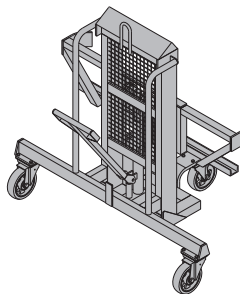
**Winch 125**
Zahnstangenwinde 125

63.8 582780000

Painted blue
Height: 189 cm
Follow the directions in the "Operating Instructions"!

CE

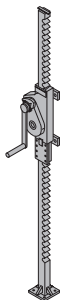
**Fork lift shifting device TG**
Umsetzgerät TG für Stapler

83.0 582797000

Galvanised
Length: 60 cm
Width: 113 cm
Height: 52 cm
Follow the directions in the "Operating Instructions"!

CE

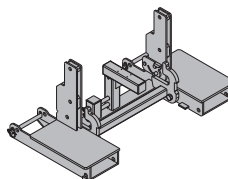
**Staxo/d2 adapter frame**
Staxo/d2-Adapter

14.1 582781000

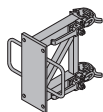
Painted blue
Length: 37 cm
Width: 36 cm
Height: 36 cm**Multi-purpose waling WS10 Top50 2.00m**
Mehrzweckriegel WS10 Top50 2,00m

38.9 580007000

Painted blue

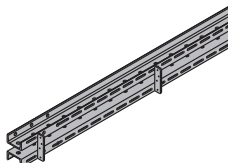
**Solid tire wheel**
Vollelastikrad

34.5 582573000

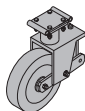
Painted blue
Height: 45 cm**Connecting pin 10cm**
Verbindungsbolzen 10cm

0.34 580201000

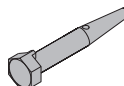
Galvanised
Length: 14 cm**Heavy duty wheel 15kN**
Schwerlastrad 15kN

33.0 582575000

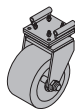
Painted blue
Height: 41 cm**Spring cotter 5mm**
Federvorstecker 5mm

0.05 580204000

Galvanised
Length: 13 cm**Double wheeled transporter**
Zweirad-Transportroller

5.0 582558000

Painted blue
Width: 57 cm**Fix-De-Fix remote uncoupling system 3150kg**
Abhängeautomat Fix-De-Fix 3150kg

27.0 586014000

Follow the directions in the "Operating Instructions"!

CE

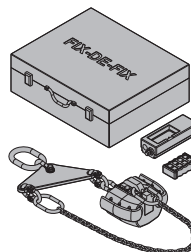
**Pallet for Staxo/Aluxo**
Doka-Traggerüstpalette

64.6 582783000

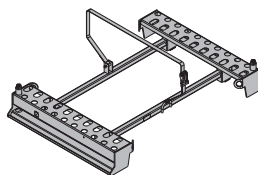
Galvanised
Length: 180 cm
Width: 120 cm
Height: 29 cm
Follow the directions in the "Operating Instructions"!

Doka stacking pallet 1.55x0.85m

42.0 586151000

Doka-Stapelpalette 1,55x0,85m

Galvanised

Height: 77 cm

Follow the directions in the "Operating Instructions"!

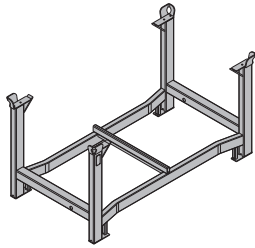

Bolt-on castor set B

33.6 586168000

Anklemm-Radsatz B

Painted blue

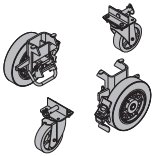

Doka Safety Systems



You will find working and protection platforms, guardrail systems and access systems in the section headed "Doka Safety Systems".