

Formwork element FF20 2.00x2.75m 21mm	335.0	587512000
Formwork element FF20 1.00x2.75m 21mm	166.0	587508000
Formwork element FF20 0.75x2.75m 21mm	131.0	587504000
Formwork element FF20 0.50x2.75m 21mm	92.0	587500000
Formwork element FF20 2.00x1.00m 21mm	190.0	587523000
Formwork element FF20 1.00x1.00m 21mm	95.0	587522000
Formwork element FF20 0.75x1.00m 21mm	79.5	587521000
Formwork element FF20 0.50x1.00m 21mm	58.0	587520000
Formwork element FF20 2.00x3.75m 21mm	440.0	587564000
Formwork element FF20 1.00x3.75m 21mm	224.0	587562000
Formwork element FF20 0.75x3.75m 21mm	172.0	587561000
Formwork element FF20 0.50x3.75m 21mm	120.0	587560000
Formwork element FF20 2.00x6.50m 21mm	692.0	587563000
Formwork element FF20 1.00x6.50m 21mm	346.0	587565000
Formwork element FF20 0.75x6.50m 21mm	272.0	587566000
Formwork element FF20 0.50x6.50m 21mm	189.5	587567000
Fertigelement FF20 21mm		

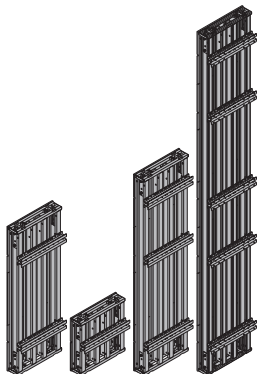

Inside corner FF20 2.75m 21mm	214.0	587516000
Inside corner FF20 1.00m 21mm	117.0	587525000
Innenecke FF20 21mm		

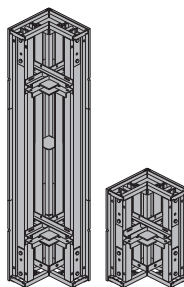

Formwork element FF20 2.00x2.75m 27mm	348.0	587606000
Formwork element FF20 1.00x2.75m 27mm	173.0	587604000
Formwork element FF20 0.75x2.75m 27mm	136.0	587602000
Formwork element FF20 0.50x2.75m 27mm	96.0	587600000
Formwork element FF20 2.00x1.00m 27mm	195.0	587616000
Formwork element FF20 1.00x1.00m 27mm	103.0	587614000
Formwork element FF20 0.75x1.00m 27mm	81.5	587612000
Formwork element FF20 0.50x1.00m 27mm	59.5	587610000
Fertigelement FF20 27mm		

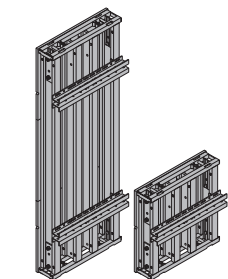

Inside corner FF20 2.75m 27mm	220.0	587608000
Inside corner FF20 1.00m 27mm	120.0	587618000
Inside corner FF20 0.50m 27mm	33.5	587628000
Innenecke FF20 27mm		

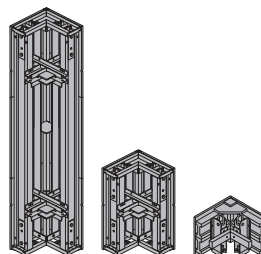

Formwork element FF20 2.00x2.75m 27mm	348.0	587606000
Formwork element FF20 1.00x2.75m 27mm	173.0	587604000
Formwork element FF20 0.75x2.75m 27mm	136.0	587602000
Formwork element FF20 0.50x2.75m 27mm	96.0	587600000
Formwork element FF20 2.00x1.00m 27mm	195.0	587616000
Formwork element FF20 1.00x1.00m 27mm	103.0	587614000
Formwork element FF20 0.75x1.00m 27mm	81.5	587612000
Formwork element FF20 0.50x1.00m 27mm	59.5	587610000
Fertigelement FF20 27mm		

Swivelling inside corner FF20 2.75m 21mm	246.5	587577000
Swivelling inside corner FF20 1.00m 21mm	103.0	587575000
Swivelling inside corner FF20 0.50m 21mm	53.7	587573000
Gelenkinnenecke FF20 21mm		

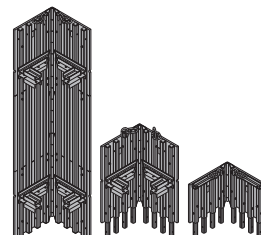

Stacking element FF20 2.00x0.50m 21mm	90.5	587529000
Stacking element FF20 1.00x0.50m 21mm	45.4	587528000
Stacking element FF20 0.75x0.50m 21mm	36.4	587527000
Stacking element FF20 0.50x0.50m 21mm	27.5	587526000
Aufstockelement FF20 21mm		



Swivelling inside corner FF20 0.50m 27mm	55.0	587647000
Swivelling inside corner FF20 1.00m 27mm	108.8	587649000
Swivelling inside corner FF20 2.75m 27mm	255.0	587651000
Gelenkinnenecke FF20 27mm		

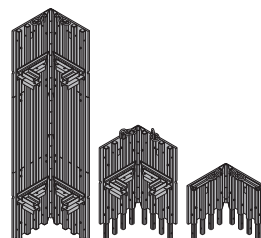

Stacking element FF20 2.00x0.50m 27mm	67.5	587626000
Stacking element FF20 1.00x0.50m 27mm	33.4	587624000
Stacking element FF20 0.75x0.50m 27mm	28.8	587622000
Stacking element FF20 0.50x0.50m 27mm	21.0	587620000
Aufstockelement FF20 27mm		



Swivelling outside corner FF20 2.75m 21mm	102.7	587579000
Swivelling outside corner FF20 1.00m 21mm	46.2	587578000
Gelenkaußenecke FF20 21mm		

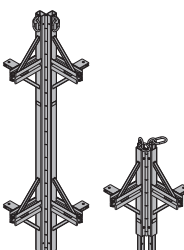

Painted blue

[kg] Article n°

**Swivelling outside corner FF20 2.75m 27mm** 102.7 587654000  
**Swivelling outside corner FF20 1.00m 27mm** 46.2 587653000  
 Gelenkaußenecke FF20 27mm

Painted blue

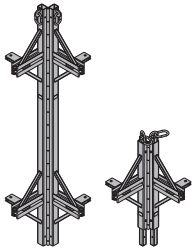

**Swivelling outside corner FF20 0.50m** 16.1 587652000  
 Gelenkaußenecke FF20 0,50m

Painted blue



**Corner plate FF20 G** 7.2 587571000  
 Ecklasche FF20 G

Painted blue  
 Length: 49 cm  
 Width: 24 cm

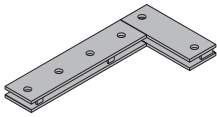

**Fastening bolt FF20** 0.30 587545000  
 Spannbolzen FF20

Galvanised  
 Length: 17 cm  
 Width-across: 30 mm

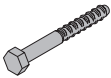

**Star grip nut 15.0 G** 0.47 587544000  
 Sternmutter 15,0 G

Galvanised  
 Width: 10 cm  
 Height: 5 cm  
 Width-across: 30 mm



**Formwork element connector FF20/50** 6.3 587530000  
 Elementverbinder FF20/50

Painted blue  
 Length: 55 cm

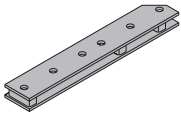

**Formwork element connector FF20/50 Z** 6.0 587533000  
 Elementverbinder FF20/50 Z

Painted blue  
 Length: 55 cm

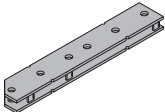

**Adjustable waling extension FF20/50** 9.1 587532000  
 Ausgleichlasche FF20/50

Painted blue  
 Length: 87 cm

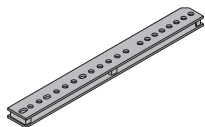

**Beam clamp Top50** 1.2 580081000  
 Trägerklammer Top50

Painted blue  
 Height: 15 cm

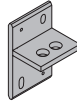

**Anchoring plate FF20/50** 6.6 587531000  
 Ankerungslasche FF20/50

Painted blue  
 Length: 55 cm

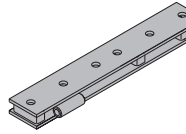

**Splice plate with join adjustment** 13.8 580215000  
 Verbindungslasche mit Fugenjustierung

Painted blue  
 Length: 76 cm

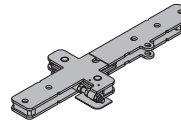

**Distribution plate FF20** 1.7 580216000  
 Verteilerplatte FF20

Galvanised  
 Width: 10.9 cm  
 Height: 12 cm



**Offset plate FF20** 6.2 587534000  
 Versatzlasche FF20

Painted blue  
 Length: 35 cm  
 Width: 18 cm  
 Height: 4 cm

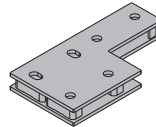

**Outside angle plate FF20 21mm** 18.6 587535000  
**Outside angle plate FF20 27mm** 18.6 587634000  
 Außenecklasche FF20

Painted blue  
 Leg length: 60 cm

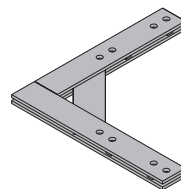

**Universal angle tie bracket** 4.4 580604000  
 Universal-Winkelspanner

Painted blue  
 Length: 20 cm

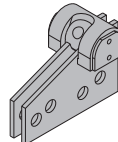

**Connecting pin 10cm** 0.34 580201000  
 Verbindungsbolzen 10cm

Galvanised  
 Length: 14 cm

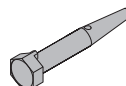

	[kg]	Article n°
<b>Spring cotter 5mm</b> Federvorstecker 5mm	0.05	580204000
	Galvanised	Length: 13 cm

<b>Flange clamp H20</b> Flanschklammer H20	1.0	580135000
	Galvanised	Width: 13 cm Width-across: 19 mm

<b>Stacking angle FF20</b> Aufstockwinkel FF20	7.8	587547000
	Painted blue	Height: 46 cm

<b>Multi-purpose waling WS10 Top50 0.50m</b>	10.2	580001000
<b>Multi-purpose waling WS10 Top50 0.75m</b>	14.9	580002000
<b>Multi-purpose waling WS10 Top50 1.00m</b>	19.6	580003000
<b>Multi-purpose waling WS10 Top50 1.25m</b>	24.7	580004000
<b>Multi-purpose waling WS10 Top50 1.50m</b>	29.7	580005000
<b>Multi-purpose waling WS10 Top50 1.75m</b>	35.0	580006000
<b>Multi-purpose waling WS10 Top50 2.00m</b>	38.9	580007000
<b>Multi-purpose waling WS10 Top50 2.25m</b>	44.2	580008000
<b>Multi-purpose waling WS10 Top50 2.50m</b>	48.7	580009000
<b>Multi-purpose waling WS10 Top50 2.75m</b>	54.2	580010000
<b>Multi-purpose waling WS10 Top50 3.00m</b>	60.2	580011000
<b>Multi-purpose waling WS10 Top50 3.50m</b>	68.4	580012000
<b>Multi-purpose waling WS10 Top50 4.00m</b>	79.4	580013000
<b>Multi-purpose waling WS10 Top50 4.50m</b>	89.1	580014000
<b>Multi-purpose waling WS10 Top50 5.00m</b>	102.0	580015000
<b>Multi-purpose waling WS10 Top50 5.50m</b>	112.4	580016000
<b>Multi-purpose waling WS10 Top50 6.00m</b>	118.0	580017000

<b>Mehrzweckriegel WS10 Top50</b>	Painted blue
	

	[kg]	Article n°
<b>Panel strut 340</b> Elementstütze 340	30.2	588246000
consisting of:		
(A) <b>Prop head</b> 2 pcs. Galvanised Length: 40.8 cm Width: 11.8 cm Height: 17.6 cm	3.5	588244000
(B) <b>Prop shoe</b> Galvanised Length: 20 cm Width: 11 cm Height: 10 cm	2.1	588245000
(C) <b>Plumbing strut 340</b> Galvanised Length: 190 - 341 cm	14.2	588247000
(D) <b>Adjusting strut 120</b> Galvanised Length: 80 - 130 cm	7.2	588248000

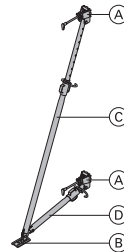

Galvanised  
Delivery condition: folded closed

<b>Panel strut 540</b> Elementstütze 540	49.0	588249000
consisting of:		
(A) <b>Prop head</b> 2 pcs. Galvanised Length: 40.8 cm Width: 11.8 cm Height: 17.6 cm	3.5	588244000
(B) <b>Prop shoe</b> Galvanised Length: 20 cm Width: 11 cm Height: 10 cm	2.1	588245000
(C) <b>Plumbing strut 540</b> Galvanised Length: 309 - 550 cm	29.6	588250000
(D) <b>Adjusting strut 220</b> Length: 171 - 224 cm	10.2	588251000

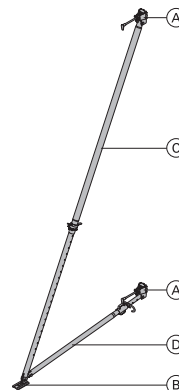

Galvanised  
Delivery condition: folded closed

**Eurex 60 550**

Eurex 60 550

depending on length, comprising:

- |   |                       |
|---|-----------------------|
| (A) <b>Plumbing strut Eurex 60 550</b><br>Powder-coated, blue<br>Aluminium<br>Length: 343 - 553 cm      | <b>42.5 582658000</b> |
| (B) <b>Extension Eurex 60 2.00m</b><br>Powder-coated, blue<br>Aluminium<br>Length: 250 cm               | <b>21.3 582651000</b> |
| (C) <b>Coupler Eurex 60</b><br>Aluminium<br>Length: 100 cm<br>Diameter: 12.8 cm                         | <b>8.6 582652000</b>  |
| (D) <b>Connector Eurex 60</b><br>Galvanised<br>Length: 15 cm<br>Width: 15 cm<br>Height: 30 cm           | <b>3.9 582657000</b>  |
| (E) <b>Plumbing strut shoe Eurex 60</b><br>Galvanised<br>Length: 31 cm<br>Width: 12 cm<br>Height: 33 cm | <b>8.5 582660000</b>  |
| (F) <b>Adjusting strut 540 Eurex 60</b><br>Galvanised<br>Length: 302 - 543 cm                           | <b>29.0 582659000</b> |
| (G) <b>Prop head</b><br>2 pcs.<br>Galvanised<br>Length: 40.8 cm<br>Width: 11.8 cm<br>Height: 17.6 cm    | <b>3.5 588244000</b>  |

Delivery condition: separate parts

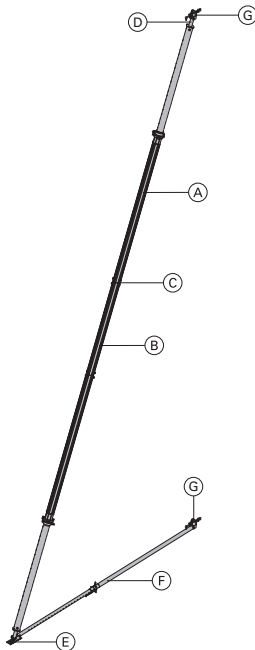
**Universal dismantling tool**

Universal-Lösewerkzeug

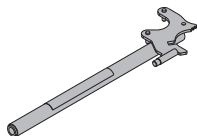
**3.7 582768000**Galvanised  
Length: 75.5 cm**Doka express anchor 16x125mm**

Doka-Expressanker 16x125mm

**0.31 588631000**Galvanised  
Length: 18 cm  
Follow fitting instructions!**Doka coil 16mm**

Doka-Coil 16mm

**0.009 588633000**Galvanised  
Diameter: 1.6 cm**Top scaffold bracket L**

Betonierkonsole L

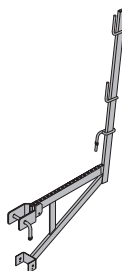
**12.6 587153500**Galvanised  
Length: 101 cm  
Height: 159 cm**Top scaffold bracket L painted**

Betonierkonsole L lackiert

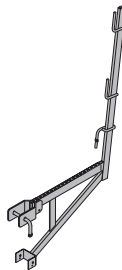
**12.0 587153000**Painted blue  
Length: 101 cm  
Height: 159 cm**Universal bracket 60**

Universal-Konsole 60

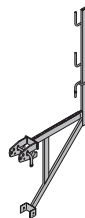
**14.0 580477000**Galvanised  
Length: 86 cm  
Height: 181 cm**Universal bracket 90**

Universal-Konsole 90

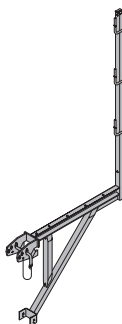
**30.4 580476000**Galvanised  
Length: 121 cm  
Height: 235 cm

[kg] Article n°

**Universal railing shackle**

Universal-Geländerbügel

Galvanised  
Height: 20 cm

3.0 580478000

**Side handrail clamping unit T**

Seitenschutzgeländer T

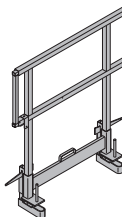
Galvanised  
Length: 115 - 175 cm  
Height: 112 cm

29.1 580488000



Scaffold tube 48.3mm 1.00m  
Scaffold tube 48.3mm 1.50m  
Scaffold tube 48.3mm 2.00m  
Scaffold tube 48.3mm 2.50m  
Scaffold tube 48.3mm 3.00m  
Scaffold tube 48.3mm 3.50m  
Scaffold tube 48.3mm 4.00m  
Scaffold tube 48.3mm 4.50m  
Scaffold tube 48.3mm 5.00m  
Scaffold tube 48.3mm 5.50m  
Scaffold tube 48.3mm 6.00m  
Scaffold tube 48.3mm .....m  
Gerüstrohr 48,3mm

3.6 682014000  
5.4 682015000  
7.2 682016000  
9.0 682017000  
10.8 682018000  
12.6 682019000  
14.4 682021000  
16.2 682022000  
18.0 682023000  
19.8 682024000  
21.6 682025000  
3.6 682001000

Galvanised

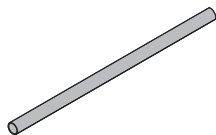
**Scaffold tube connection**

Gerüstrohranschluss

Galvanised  
Height: 7 cm

0.27 584375000

**Screw-on coupler 48mm 50**

Anschraubkupplung 48mm 50

Galvanised  
Width-across: 22 mm

0.84 682002000

**Framax pouring platform U 1.25/2.70m**

Framax-Betonierbühne U 1,25/2,70m

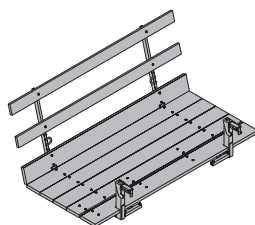
Steel parts galvanised  
Timber parts varnished yellow  
Delivery condition: folded closed

127.5 588377000

**Lifting chain 100cm 15kN**

Anschlagkette 100cm 15kN

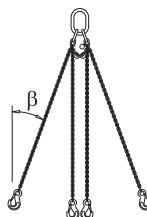

Follow the directions in the "Operating Instructions"!

CE

**FF20 adapter for Framax pouring platform U**

FF20-Adapter f. Framax-Betonierbühne U

Galvanised  
Length: 34 cm

6.8 588381000

**Dokamatic lifting strap 13.00m**

Dokamatic-Umsetzgurt 13,00m

Green  
Follow the directions in the "Operating Instructions"!

CE

**Top50 adapter for Framax pouring platform U**

Top50-Adapter für Framax-Betonierbühne U

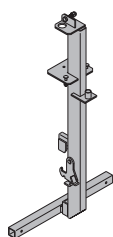
Galvanised  
Width: 75 cm  
Height: 134 cm

18.5 588384000

**Fix-De-Fix remote uncoupling system 3150kg**

Abhängeautomat Fix-De-Fix 3150kg

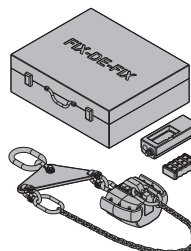

Follow the directions in the "Operating Instructions"!

CE



**Lifting bracket**

Kranöse

**6.2 580460000**

Galvanised  
Height: 59 cm

**Height adjuster for multi-purpose walings**

Höhenjustierung für Mehrzweckriegel

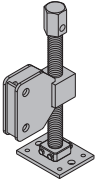
**10.3 580206000**

Galvanised  
Height: 45 cm

**Doka Safety Systems**

You will find working and protection platforms, guardrail systems and access systems in the section headed "Doka Safety Systems".