

[kg] Article n°

Multi-purpose waling WS10 Top50 1.00m
Multi-purpose waling WS10 Top50 1.25m
 Mehrzweckriegel WS10 Top50

19.6 580003000
24.7 580004000

Painted blue

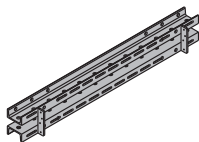

Steel waling WS10 Top50 1.00m
Steel waling WS10 Top50 1.25m
 Stahlwandriegel WS10 Top50

20.2 580040000
25.0 580041000

Painted blue

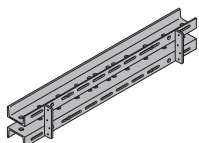

Multi-purpose waling WU12 Top50 1.50m
Multi-purpose waling WU12 Top50 1.75m
 Mehrzweckriegel WU12 Top50

37.5 580020000
44.2 580021000

Painted blue

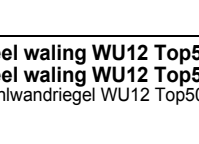

Steel waling WU12 Top50 1.50m
Steel waling WU12 Top50 1.75m
 Stahlwandriegel WU12 Top50

37.9 580087000
44.2 580088000

Painted blue

Flange clamp H20
 Flanschklammer H20

1.0 580135000

Galvanised
 Width: 13 cm
 Width-across: 19 mm

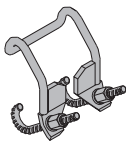

Flange clamp G
 Flanschklammer G

1.1 580120000

Galvanised
 Width: 13 cm
 Width-across: 19 mm



Lifting bracket
 Kranöse

6.2 580460000

Galvanised
 Height: 59 cm



Lifting bracket for column formwork
 Kranöse für Stützenschalung

65.0 580607000

Galvanised, powder-coated
 Length: 85 cm
 Width: 85 cm

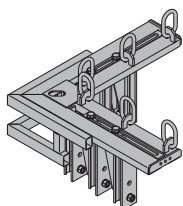

Corner connecting plate 90/50
 Winkellasche 90/50

13.8 580603000

Painted blue
 Length: 51 cm
 Width: 40 cm

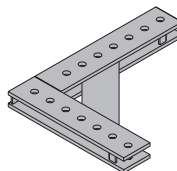

Column connecting plate 6/8
 Stützenlasche 6/8

15.0 580072000

Painted blue
 Length: 58 cm

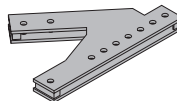

Universal angle tie bracket
 Universal-Winkelspanner

4.4 580604000

Painted blue
 Length: 20 cm

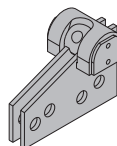

Tie rod 15.0mm galvanised 1.00m
Tie rod 15.0mm non-treated 1.00m
 Ankerstab 15,0mm 1,0m

1.4 581823000
1.4 581874000

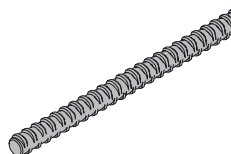

DIN
 18216

Wing nut 15.0
 Flügelmutter 15,0

0.31 581961000

Galvanised
 Length: 10 cm
 Height: 5 cm
 Width-across: 27 mm



DIN
 18216

Connecting pin 10cm
 Verbindungsbolzen 10cm

0.34 580201000

Galvanised
 Length: 14 cm

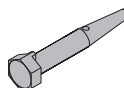

Spring cotter 5mm
 Federvorstecker 5mm

0.05 580204000

Galvanised
 Length: 13 cm



Doka express anchor 16x125mm

Doka-Expressanker 16x125mm

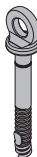
0.31 588631000

Galvanised
Length: 18 cm
Follow fitting instructions!

Doka coil 16mm

Doka-Coil 16mm

0.009 588633000

Galvanised
Diameter: 1.6 cm

Top scaffold bracket L

Betontierkonsole L

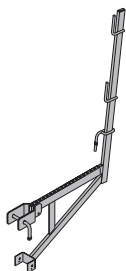
12.6 587153500

Galvanised
Length: 101 cm
Height: 159 cm

Top scaffold bracket L painted

Betontierkonsole L lackiert

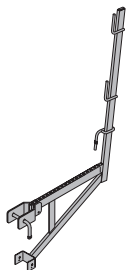
12.0 587153000

Painted blue
Length: 101 cm
Height: 159 cm

Universal bracket 60

Universal-Konsole 60

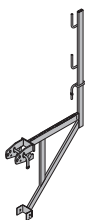
14.0 580477000

Galvanised
Length: 86 cm
Height: 181 cm

Universal bracket 90

Universal-Konsole 90

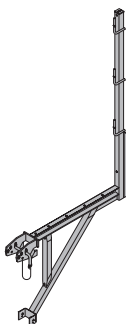
30.4 580476000

Galvanised
Length: 121 cm
Height: 235 cm

Universal railing shackle

Universal-Geländerbügel

3.0 580478000

Galvanised
Height: 20 cm

Scaffold tube 48.3mm 1.00m**Scaffold tube 48.3mm 1.50m****Scaffold tube 48.3mm 2.00m****Scaffold tube 48.3mm 2.50m****Scaffold tube 48.3mm 3.00m****Scaffold tube 48.3mm 3.50m****Scaffold tube 48.3mm 4.00m****Scaffold tube 48.3mm 4.50m****Scaffold tube 48.3mm 5.00m****Scaffold tube 48.3mm 5.50m****Scaffold tube 48.3mm 6.00m****Scaffold tube 48.3mmm**

Gerüstrohr 48,3mm

3.6 682014000**5.4 682015000****7.2 682016000****9.0 682017000****10.8 682018000****12.6 682019000****14.4 682021000****16.2 682022000****18.0 682023000****19.8 682024000****21.6 682025000****3.6 682001000**

Galvanised

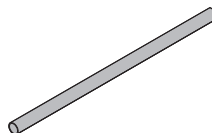
**Scaffold tube connection**

Gerüstrohranschluss

0.27 584375000

Galvanised
Height: 7 cm

Screw-on coupler 48mm 50

Anschraubkupplung 48mm 50

0.84 682002000

Galvanised
Width-across: 22 mm

Tool box GF

GF-Werkzeugbox

6.5 580390000

included in scope of supply:

(A) Reversible ratchet 1/2"**0.73 580580000**

Galvanised

Length: 30 cm

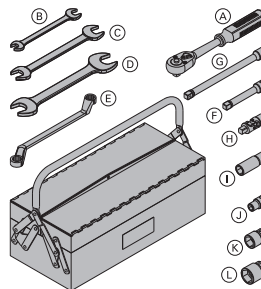
(B) Fork wrench 13/17**0.08 580577000****(C) Fork wrench 22/24****0.22 580587000****(D) Fork wrench 30/32****0.80 580897000****(E) Ring spanner 17/19****0.27 580590000****(F) Extension 11cm 1/2"****0.20 580581000****(G) Extension 22cm 1/2"****0.31 580582000****(H) Universal joint coupling****0.16 580583000****(I) Nut for box spanner 19 1/2" L****0.16 580598000****(J) Box nut 13 1/2"****0.06 580576000****(K) Box nut 24 1/2"****0.12 580584000****(L) Box nut 30 1/2"****0.20 580575000**

Assembly angle Top50
Montagelasche Top50

7.4 580082000

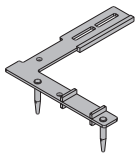

Painted blue
Length: 55 cm
Width: 48 cm

Doka Safety Systems

You will find working and protection platforms, guardrail systems and access systems in the section headed "Doka Safety Systems".

Strip tensioner B 5.00m
Bandzwinge B 5,00m

3.5 580394000

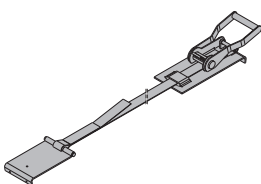

Galvanised

Hole gauge Top50
Bohrplatte Top50

2.9 580080000

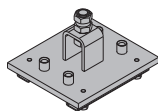

Painted blue
Length: 17 cm
Width: 15 cm
Tool: Drill bit (diameter 10 mm)

Positioning railm
Führungsschienem

1.8 580079000

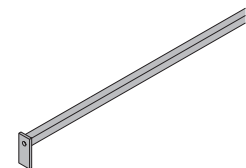

Painted blue
Weight per linear metre

Angle connector 9x5cm
Winkelverbinder 9x5cm

0.22 580381000

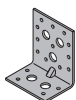

Galvanised

Rafter plate right
Rafter plate left
Sparrenpfettenanker

0.09 582521000

0.09 582522000

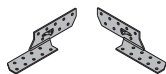

Galvanised
Length: 17 cm

Doka 4-part chain 3.20m
Doka-Vierstrangkette 3,20m

15.0 588620000

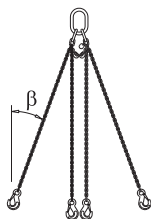

Follow the directions in the "Operating Instructions"!

