

[kg] Article n°

[kg] Article n°

**Dokaset panel 2.70x2.70m**

Dokaset-Element 2,70x2,70m

**835.0 588900000**

Galvanised  
Height: 282 cm

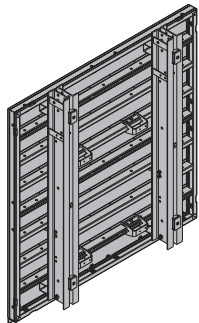

**Dokaset counter railing 2.70m**

Dokaset-Gegengeländer

**21.0 588741000**

**15.0 588742000**

Height: 183 cm



**Dokaset panel 2.70x2.70m with platform**

Dokaset-Element 2,70x2,70m mit Bühne

**986.0 588901000**

Galvanised  
Height: 282 cm  
Delivery condition: folded closed

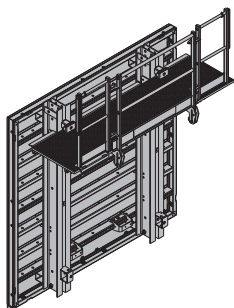

**Xsafe platform extension 0.55m**

Xsafe-Bühnenverlängerung 0,55m

**41.0 587734000**

Timber parts varnished yellow  
Steel parts galvanised

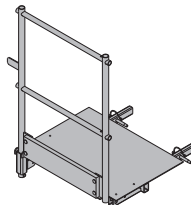

**Dokaset panel 1.35x2.70m**

Dokaset-Element 1,35x2,70m

**454.0 588902000**

Galvanised, powder-coated  
Height: 282 cm

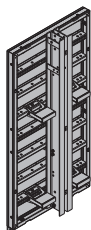

**Dokaset outside corner 3.30m**

Dokaset-Außenecke 3,30m

**283.0 588914000**



**Dokaset panel 1.35x2.70m with platform**

Dokaset-Element 1,35x2,70m mit Bühne

**538.0 588903000**

Galvanised, powder-coated  
Height: 282 cm  
Delivery condition: folded closed

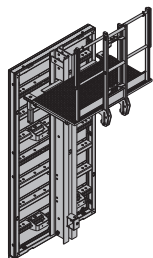

**Dokaset bottom angle for inside corner**

Dokaset-Bodenwinkel für Innenecke

**7.9 588913000**

Height: 7.5 cm



**Dokaset ladder 2.70m**

Dokaset-Leiter 2,70m

**19.7 588904000**

Galvanised  
Length: 212 cm  
Width: 37 cm



**Dokaset counter railing holder**

Dokaset-Gegengeländerhalter

**4.0 588912000**

Length: 31 cm



**Dokaset railing holder 30 degrees**

Dokaset-Geländerhalter

**2.0 588915000**

**2.0 588916000**

Galvanised  
Height: 18 cm

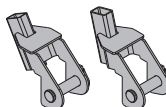

[kg] Article n°

**Handrail post 1.00m**

Geländer 1,00m

Galvanised  
Length: 124 cm**3.8 584335000****Framax wedge clamp**

Framax-Spannklemme

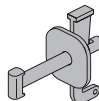
Galvanised  
Length: 21 cm**1.5 588152000****Dokaset head anchor 12-36cm**

Dokaset-Kopfancker 12-36cm

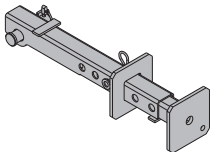
Galvanised, powder-coated  
Length: 47 - 71 cm**4.7 588905000****Dokaset universal waling holder**

Dokaset-Klemmschienenhalter

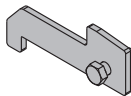
Galvanised  
Length: 24.5 cm**1.5 588927000****Dokaset tension tie 10-30cm**

Dokaset-Zuganker 10-30cm

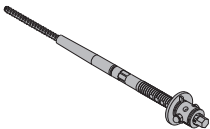
Galvanised  
Length: 115 cm**13.0 588910000****Framax universal fixing bolt 10-16cm**

Framax-Universalverbinder 10-16cm

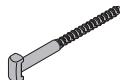
Galvanised  
Length: 26 cm**0.60 588158000****Dokaset ratchet 3/4" SW36**

Dokaset-Knarre 3/4" SW36

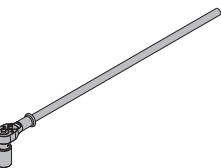
Galvanised  
Length: 100 cm**3.9 588909000****Panel strut 340**

Elementstütze 340

consisting of:

**(A) Prop head**2 pcs.  
Galvanised  
Length: 40.8 cm  
Width: 11.8 cm  
Height: 17.6 cm**3.5 588244000****(B) Prop shoe**Galvanised  
Length: 20 cm  
Width: 11 cm  
Height: 10 cm**2.1 588245000****(C) Plumbing strut 340**Galvanised  
Length: 190 - 341 cm**14.2 588247000****(D) Adjusting strut 120**Galvanised  
Length: 80 - 130 cm**7.2 588248000****Dokaset tie hole reducer 20.0**

Dokaset-Ankerlochreduktion 20,0

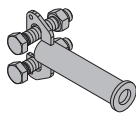
Galvanised  
Length: 20 cm**1.2 588911000**Galvanised  
Delivery condition: folded closed**Framax quick acting clamp RU**

Framax-Schnellspanner RU

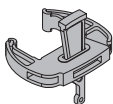
Galvanised  
Length: 20 cm**3.3 588153400****Doka express anchor 16x125mm**

Doka-Expressanker 16x125mm

Galvanised  
Length: 18 cm  
Follow fitting instructions!**0.31 588631000****Framax multi function clamp**

Framax-Uni-Spanner

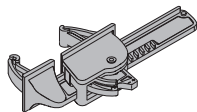
Galvanised  
Length: 40 cm**5.8 588169000****Framax universal waling 0.90m**

Framax-Klemmschiene

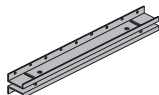

Painted blue

**10.6 588150000****16.8 588148000****Doka coil 16mm**

Doka-Coil 16mm

Galvanised  
Diameter: 1.6 cm**0.009 588633000**

**Dokaset 2-part chain 1.50m**

Dokaset-Zweistrangkette 1,50m

4.8 588917000

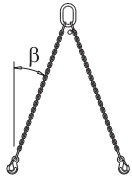

Follow the directions in the "Operating Instructions"!

**Doka 4-part chain 3.20m**

Doka-Vierstrangkette 3,20m

15.0 588620000

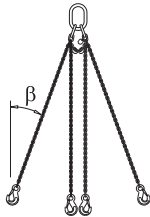

Follow the directions in the "Operating Instructions"!

**Dokaset closure cone 20cm**

Dokaset-Verschlusskonus 20cm

0.50 588925000

Length: 19.2 cm

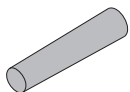
**Dokaset fibre concrete cone 30cm**

Dokaset-Faserbetonkonus 30cm

0.10 588926000

Length: 29.2 cm

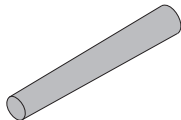
**Fibre concrete plug 35mm**

Faserbetonstopfen

0.11 588923000

Grey

**Double scraper Xlife 100/150mm 1.40m**

Doppelschaber Xlife 100/150mm 1,40m

2.8 588674000

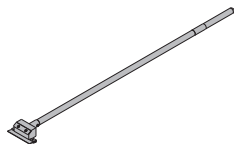
**Dokaset F****Dokaset F panel 2.70x2.70m with platform**

Dokaset F-Element 2,70x2,70m m. Bühne

984.0 588721000

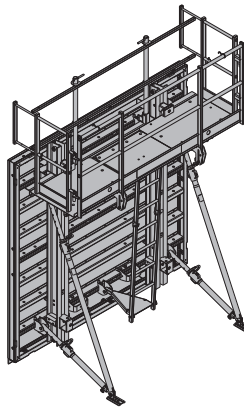
Galvanised  
Length: 284 cm  
Width: 270 cm  
Height: 40 cm  
Delivery condition: folded closed**Dokaset F panel 2.70x2.70m**

Dokaset F-Element 2,70x2,70m

810.0 588720000

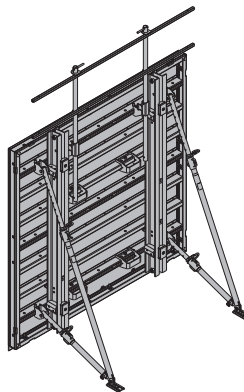
Galvanised  
Length: 284 cm  
Width: 270 cm  
Height: 33 cm  
Delivery condition: folded closed**Dokaset F panel 1.35x2.70m with platform**

Dokaset F-Element 1,35x2,70m m. Bühne

544.0 588723000

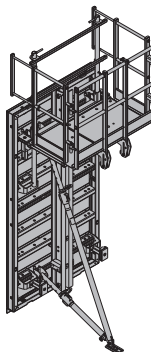
Galvanised, powder-coated  
Length: 284 cm  
Width: 135 cm  
Height: 48 cm  
Delivery condition: folded closed

**Dokaset F panel 1.35x2.70m**

Dokaset F-Element 1,35x2,70m

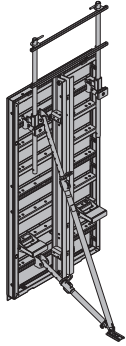
**412.0 588722000**

Galvanised, powder-coated  
 Length: 284 cm  
 Width: 135 cm  
 Height: 38 cm  
 Delivery condition: folded closed

**Dokaset F back railing 2.70m**

Dokaset F back railing 1.35m

Dokaset F-Rückengeländer

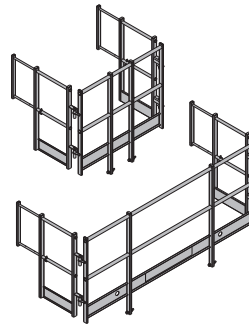
**66.0 588735000****55.0 588736000**

Galvanised  
 Delivery condition: folded closed

**Dokaset F sub panel 2.70x1.35m**

Dokaset F-Unterstockelement 2,70x1,35m

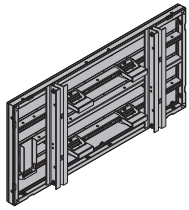
**360.0 588724000**

Galvanised, powder-coated  
 Length: 141 cm  
 Width: 270 cm  
 Height: 33 cm

**Dokaset F handrail lengthening piece 1.35m**

Dokaset F-Geländerverlängerung 1,35m

**6.0 588733000**

Galvanised  
 Length: 140 cm

**Dokaset F sub panel 1.35x1.35m**

Dokaset F-Unterstockelement 1,35x1,35m

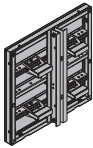
**194.0 588725000**

Galvanised, powder-coated  
 Length: 141 cm  
 Width: 135 cm  
 Height: 33 cm

**Dokaset F ladder 2.70m**

Dokaset F-Leiter 2,70m

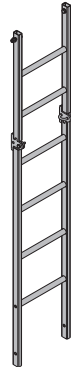
**12.0 588737000**

Galvanised  
 Length: 204 cm  
 Width: 37 cm

**Dokaset F spindle 10cm**

Dokaset F-Spindel 10cm

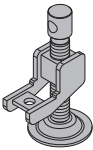
**4.6 588732000**

Galvanised  
 Height: 27 cm

**Dokaset F platform decking 2.70m**

Dokaset F platform decking 1.35m

Dokaset F-Bühnenbelag

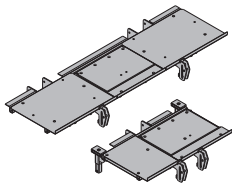
**112.0 588726000****72.0 588727000**

Galvanised  
 Painted blue

**Dokaset F ladder extension 1.35m**

Dokaset F-Leiternverlängerung 1,35m

**8.6 588728000**

Galvanised  
 Length: 141 cm  
 Width: 37 cm

**Dokaset F ladder step board**

Dokaset F-Leiterntrittbrett

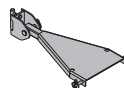
**8.2 588738000**

Galvanised  
 Length: 68 cm  
 Width: 31 cm

**Xsafe ladder support**

Xsafe-Leiternstütze

**1.1 587745000****Dokaset F supporting strut**

Dokaset F-Stützenstrebe

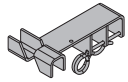
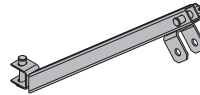
**7.0 588730000**Galvanised  
Length: 19 cmGalvanised  
Length: 108 cm**Dokaset F stacking plate**

Dokaset F-Aufstocklasche

**11.5 588729000****Universal dismantling tool**

Universal-Lösewerkzeug

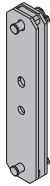
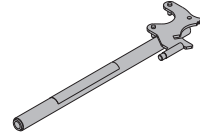
**3.7 582768000**Painted blue  
Length: 58 cmGalvanised  
Length: 75.5 cm**Framax quick acting clamp RU**

Framax-Schnellspanner RU

**3.3 588153400****Doka express anchor 16x125mm**

Doka-Expressanker 16x125mm

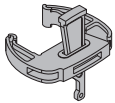
**0.31 588631000**Galvanised  
Length: 20 cmGalvanised  
Length: 18 cm  
Follow fitting instructions!**Dokaset box 30x26cm**

Dokaset-Box 30x26cm

**6.4 588734000****Doka coil 16mm**

Doka-Coil 16mm

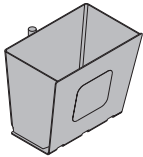
**0.009 588633000**

Galvanised

Galvanised  
Diameter: 1.6 mm**Prop head**

Stützenkopf

**3.5 588244000****Universal plug R20/25**

Kombi Ankerstopfen R20/25

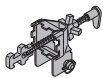
**0.003 588180000**Galvanised  
Length: 40.8 cm  
Width: 11.8 cm  
Height: 17.6 cmBlue  
Diameter: 3 cm**Panel strut 540 without prop head**Elementstütze 540 ohne Stützenkopf  
consisting of:**42.2 580366000****Dokaset 2-part chain 1.50m**

Dokaset-Zweistrangkette 1,50m

**4.8 588917000****(A) Plumbing strut 540**Galvanised  
Length: 309 - 550 cm**29.6 588250000****(B) Adjusting strut 220**

Length: 171 - 224 cm

**10.2 588251000****(C) Prop shoe**Galvanised  
Length: 20 cm  
Width: 11 cm  
Height: 10 cm**2.1 588245000**

Follow the directions in the "Operating Instructions"!

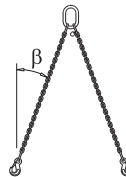
**Lifting chain 100cm 15kN**

Anschlagkette 100cm 15kN

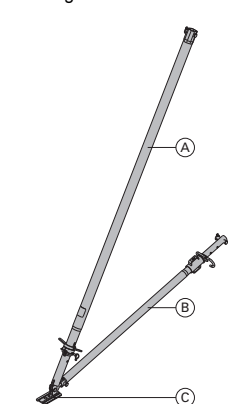
**1.8 587548000**Length: 103 cm  
Follow the directions in the "Operating Instructions"!Galvanised  
Delivery condition: folded closed**Doka stacking pallet 1.55x0.85m**

Doka-Stapelpalette 1,55x0,85m

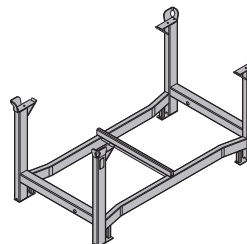
**42.0 586151000**Galvanised  
Height: 77 cm  
Follow the directions in the "Operating Instructions"!

**Doka stacking pallet 1.20x0.80m****39.5 583016000**

Doka-Stapelpalette 1,20x0,80m

Galvanised  
 Height: 77 cm  
 Follow the directions in the "Operating Instructions"!

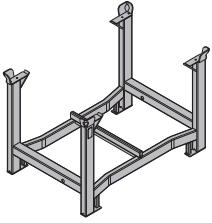
**Doka accessory box****106.4 583010000**

Doka-Kleinteilebox

Timber parts varnished yellow  
 Steel parts galvanised  
 Length: 154 cm  
 Width: 83 cm  
 Height: 77 cm  
 Follow the directions in the "Operating Instructions"!

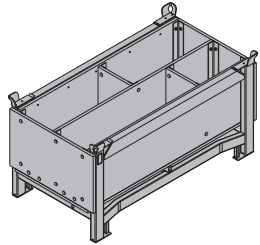
**Bolt-on castor set B****33.6 586168000**

Anklemm-Radsatz B

Painted blue

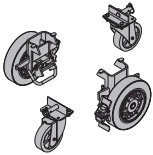
**Dokaset F anchoring nut 20.0****2.0 588731000**

Dokaset F-Ankermutter 20,0

Galvanised  
 Length: 13 cm

