

[kg] Article n°

[kg] Article n°

**Xlife panel KS 3.30m**  
Xlife-Element KS 3,30m

**185.0 580346500**

Galvanised  
Width: 80 cm  
Delivery condition: folded closed

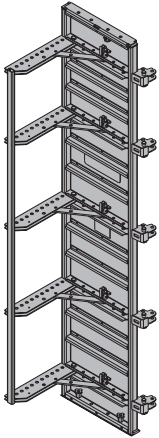

**Protective plate KS top**  
Schutzleiste KS oben

**3.0 580357000**

Galvanised  
Length: 65.3 cm  
Width: 8.4 cm

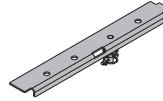

**Locking hook KS**  
Verschlusshaken KS

**0.83 580344000**

Galvanised  
Length: 31 cm

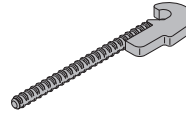

**Super plate 15.0**  
Superplatte 15,0

**1.1 581966000**

Galvanised  
Height: 6 cm  
Diameter: 12 cm  
Width-across: 27 mm

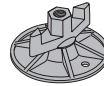

**Xlife panel KS 2.70m**  
Xlife-Element KS 2,70m

**140.0 580337500**

Galvanised  
Width: 80 cm  
Delivery condition: folded closed

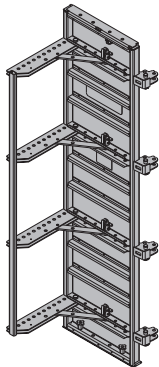

**Lifting ring**  
Umsetzring

**1.4 580340000**

Galvanised  
Height: 20 cm

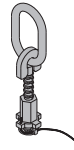

**Stacking screw KS**  
Aufstockschraube KS

**0.77 580345000**

Galvanised  
Height: 20 cm



**Xlife panel KS 1.20m**  
Xlife-Element KS 1,20m

**66.0 580338500**

Galvanised  
Width: 80 cm  
Delivery condition: folded closed

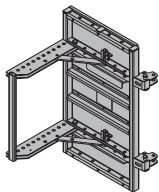

**Frontal triangular ledge KS 20 4.00m**  
**Frontal triangular ledge KS 15 4.00m**  
Stimdreikanteleiste KS

**0.93 580347000**  
**0.71 580359000**

Grey



**Xlife panel KS 0.90m**  
Xlife-Element KS 0,90m

**56.0 580339500**

Galvanised  
Width: 80 cm  
Delivery condition: folded closed

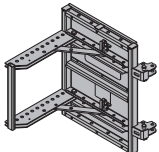

**Framax triangular ledge 2.70m**  
Framax-Dreikanteleiste 2,70m

**0.38 588170000**



**Protective plate KS**  
Schutzleiste KS

**3.3 580343000**

Galvanised  
Length: 70 cm  
Width: 9 cm

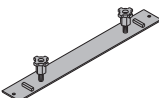

[kg] Article n°

**Panel strut 340 without prop head**

Elementstütze 340 ohne Stützenkopf

consisting of:

**(A) Plumbing strut 340**

Galvanised

Length: 190 - 341 cm

**(B) Adjusting strut 120**

Galvanised

Length: 80 - 130 cm

**(C) Prop shoe**

Galvanised

Length: 20 cm

Width: 11 cm

Height: 10 cm

Galvanised

Delivery condition: folded closed

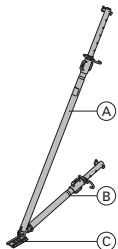
**24.0 580365000****Panel strut 340**

Elementstütze 340

consisting of:

**(A) Prop head**

2 pcs.

Galvanised

Length: 40.8 cm

Width: 11.8 cm

Height: 17.6 cm

**(B) Prop shoe**

Galvanised

Length: 20 cm

Width: 11 cm

Height: 10 cm

**(C) Plumbing strut 340**

Galvanised

Length: 190 - 341 cm

**(D) Adjusting strut 120**

Galvanised

Length: 80 - 130 cm

Galvanised

Delivery condition: folded closed

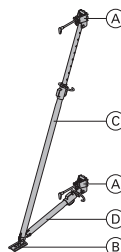
**30.2 588246000****Panel strut 540 without prop head**

Elementstütze 540 ohne Stützenkopf

consisting of:

**(A) Plumbing strut 540**

Galvanised

Length: 309 - 550 cm

**(B) Adjusting strut 220**

Galvanised

Length: 171 - 224 cm

**(C) Prop shoe**

Galvanised

Length: 20 cm

Width: 11 cm

Height: 10 cm

Galvanised

Delivery condition: folded closed

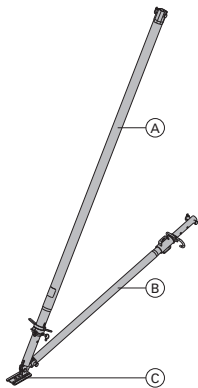
**42.2 580366000****Panel strut 540**

Elementstütze 540

consisting of:

**(A) Prop head**

2 pcs.

Galvanised

Length: 40.8 cm

Width: 11.8 cm

Height: 17.6 cm

**(B) Prop shoe**

Galvanised

Length: 20 cm

Width: 11 cm

Height: 10 cm

**(C) Plumbing strut 540**

Galvanised

Length: 309 - 550 cm

**(D) Adjusting strut 220**

Galvanised

Length: 171 - 224 cm

Galvanised

Delivery condition: folded closed

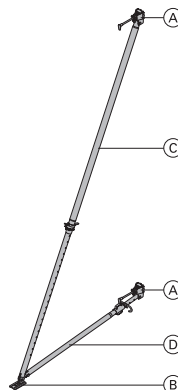
**49.0 588249000****Universal dismantling tool**

Universal-Lösewerkzeug

Galvanised

Length: 75.5 cm

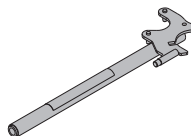
**3.7 582768000**

**Prop head KS**

Stützenkopf KS

**0.85 580342000**

Galvanised  
Length: 14 cm  
Width: 11 cm  
Height: 14 cm

**Side railing KS 0.30m**

Seitengeländer KS 0,30m

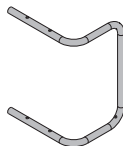
**2.6 580364000**

Galvanised  
Length: 38 cm  
Width: 30 cm  
Height: 53 cm

**Doka express anchor 16x125mm**

Doka-Expressanker 16x125mm

**0.31 588631000**

Galvanised  
Length: 18 cm  
Follow fitting instructions!

**Shifting wheel KS**

Umsetzrad KS

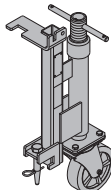
**15.8 580358000**

Galvanised  
Follow the directions in the "Operating Instructions"!

**Doka coil 16mm**

Doka-Coil 16mm

**0.009 588633000**

Galvanised  
Diameter: 1.6 cm

**Doka 4-part chain 3.20m**

Doka-Vierstrangkette 3,20m

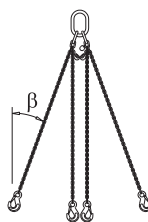
**15.0 588620000**

Follow the directions in the "Operating Instructions"!

**Platform adapter KS**

Bühnenanschluss KS

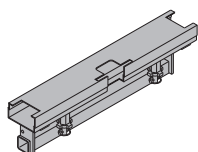
**11.4 580341000**

Galvanised  
Length: 74 cm  
Width: 12 cm  
Height: 20 cm

**Doka column formwork platform 150/90cm**

Doka-Stützenbühne 150/90cm

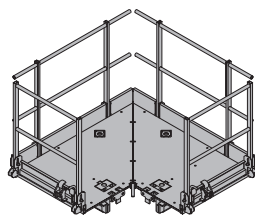
**211.8 588382000**

Galvanised  
Length: 173 cm  
Width: 173 cm  
Height: 130 cm  
Delivery condition: folded closed

**Connecting pin 10cm**

Verbindungsbolzen 10cm

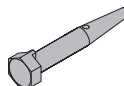
**0.34 580201000**

Galvanised  
Length: 14 cm

**Platform planking KS**

Fertigbelag KS

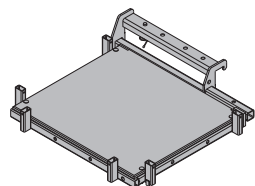
**32.3 580360000**

Timber parts varnished yellow  
Steel parts galvanised  
Length: 90 cm  
Width: 85 cm

**Doka Safety Systems**

You will find working and protection platforms, guardrail systems and access systems in the section headed "Doka Safety Systems".

**Railing KS 1.00x0.85m**

Fertigeländer KS 1,00x0,85m

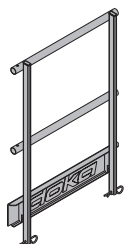
**12.4 580363000**

Galvanised