

	[kg]	Article n°		[kg]	Article n°
Doka floor prop Eurex 20 top 150 Length: 92 - 150 cm	8.0	586096000	Doka floor prop Eurex 30 top 250 Length: 148 - 250 cm	12.8	586092400
Doka floor prop Eurex 20 top 250 Length: 148 - 250 cm	12.7	586086400	Doka floor prop Eurex 30 top 300 Length: 173 - 300 cm	16.4	586093400
Doka floor prop Eurex 20 top 300 Length: 173 - 300 cm	14.3	586087400	Doka floor prop Eurex 30 top 350 Length: 198 - 350 cm	20.7	586094400
Doka floor prop Eurex 20 top 350 Length: 198 - 350 cm	17.4	586088400	Doka floor prop Eurex 30 top 400 Length: 223 - 400 cm	24.6	586095400
Doka floor prop Eurex 20 top 400 Length: 223 - 400 cm	21.6	586089400	Doka floor prop Eurex 30 top 450 Length: 248 - 450 cm	29.1	586119400
Doka floor prop Eurex 20 top 550 Length: 298 - 550 cm	32.3	586090400	Doka floor prop Eurex 30 top 550 Length: 303 - 550 cm	38.6	586129000
Doka-Deckenstütze Eurex 20 top			Doka-Deckenstütze Eurex 30 top		

Galvanised



Galvanised



Doka floor prop Eurex 20 250 Length: 152 - 250 cm	12.9	586086000	Doka floor prop Eurex 30 250 Length: 152 - 250 cm	14.8	586092000
Doka floor prop Eurex 20 300 Length: 172 - 300 cm	15.3	586087000	Doka floor prop Eurex 30 300 Length: 172 - 300 cm	16.7	586093000
Doka floor prop Eurex 20 350 Length: 197 - 350 cm	17.8	586088000	Doka floor prop Eurex 30 350 Length: 197 - 350 cm	20.5	586094000
Doka floor prop Eurex 20 400 Length: 227 - 400 cm	22.2	586089000	Doka floor prop Eurex 30 400 Length: 227 - 400 cm	24.9	586095000
Doka floor prop Eurex 20 550 Length: 297 - 550 cm	34.6	586090000	Doka floor prop Eurex 30 450 Length: 248 - 450 cm	29.2	586119000
Doka-Deckenstütze Eurex 20			Doka-Deckenstütze Eurex 30		

Galvanised



Galvanised

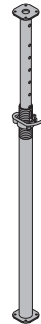

[kg] Article n°

[kg] Article n°

Doka floor prop Eco 20 250

Length: 152 - 250 cm

11.7 586134000

Doka floor prop Eco 20 300

Length: 172 - 300 cm

13.0 586135000

Doka floor prop Eco 20 350

Length: 197 - 350 cm

15.3 586136000

Doka floor prop Eco 20 400

Length: 227 - 400 cm

19.1 586137000

Doka-Deckenstütze Eco 20

Galvanised

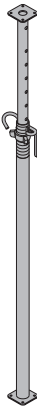
**U-head 12.5cm**

Kopfgabel 12,5cm

1.2 586171000

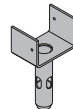

Galvanised

Height: 23 cm

Bracing clamp B

Verschwertungsklammer B

1.4 586195000

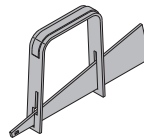

Painted blue

Length: 36 cm

Universal end-shutter support 30cm

Universal-Abschalwinkel 30cm

1.0 586232000



Galvanised

Height: 21 cm

Removable folding tripod

Stützbein

15.6 586155000

Galvanised

Height: 100 cm

Delivery condition: folded closed

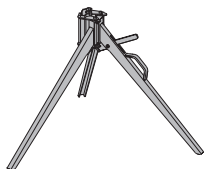
**Beam forming support 20**

Balkenzwinde 20

6.9 586148000

Galvanised

Length: 30 cm

Height: 35 cm

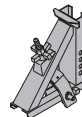
**Extension for beam forming support 60cm**

Balkenaufsatz 60cm

4.4 586149000

Galvanised

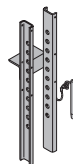
**Lowering head H20**

Absenkkopf H20

6.1 586174000

Galvanised

Length: 25 cm

Width: 20 cm

Height: 38 cm

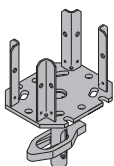
**Doka floor end-shutter clamp**

Doka-Deckenabschalcklemme

12.5 586239000

Galvanised

Height: 137 cm

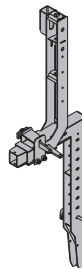
**4-way head H20**

Vierwegkopf H20

4.0 586170000

Galvanised

Length: 25 cm

Width: 20 cm

Height: 33 cm

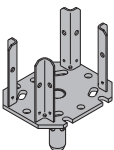
**Spring locked connecting pin 16mm**

Federbolzen 16mm

0.25 582528000

Galvanised

Length: 15 cm

**End-shutter shoe**

Abschalschuh

1.6 586257000

Galvanised

Height: 13.5 cm

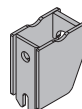
**Supporting head H20 DF**

Haltekopf H20 DF

0.77 586179000

Galvanised

Length: 19 cm

Width: 11 cm

Height: 8 cm

**End-shutter tie rod 15.0 15-40cm**

Abschalanker 15,0 15-40cm

0.91 586258000

Galvanised

Length: 55 cm



[kg] Article n°

[kg] Article n°

Wheel-around scaffold DF

Mobilgerüst DF

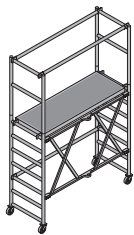
44.0 586157000

Aluminium
 Length: 195 cm
 Width: 80 cm
 Height: 290 cm
 Follow the directions in the "Operating Instructions"!

Lever extension DF 1.20m

Hebelverlängerung DF 1,20m

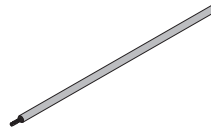
2.0 586159000

Powder-coated yellow

Doka stacking pallet 1.55x0.85m

Doka-Stapelpalette 1,55x0,85m

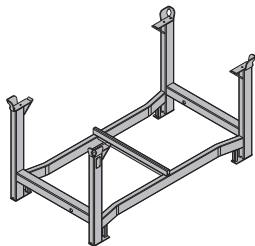
42.0 586151000

Galvanised
 Height: 77 cm
 Follow the directions in the "Operating Instructions"!

Doka beam H20 top N 2.65m

Doka-Träger H20 top N

13.8 189013000

Doka-Träger H20 top N

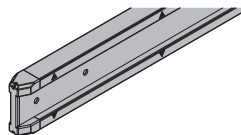
20.0 189017000

Varnished yellow

Bolt-on castor set B

Anklemm-Radsatz B

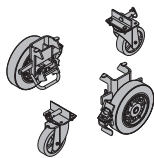
33.6 586168000

Painted blue

Doka beam H20 top P 2.65m

Doka-Träger H20 top P

14.3 189703000

Doka-Träger H20 top P

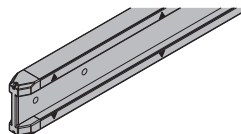
20.8 189707000

Varnished yellow

Universal dismantling tool

Universal-Lösewerkzeug

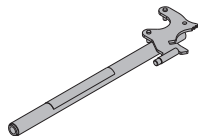
3.7 582768000

Galvanised
 Length: 75.5 cm

ProFrame panel 21mm 200/50cm**11.0 186118000**

ProFrame panel 21mm 200/50cm BS

11.0 186118100

ProFrame panel 21mm 250/50cm

13.8 186117000

ProFrame panel 21mm 250/50cm BS

13.8 186117100

ProFrame-Paneel 21

ProFrame panel 27mm 200/50cm**13.5 187178000**

ProFrame panel 27mm 200/50cm BS

13.5 187178100

ProFrame panel 27mm 250/50cm

16.9 187177000

ProFrame panel 27mm 250/50cm BS

16.9 187177100

ProFrame-Paneel 27

Alu beam fork H20

Alu-Trägergabel H20

2.4 586182000

Aluminium
 Powder-coated yellow
 Length: 176 cm

Doka Safety Systems

You will find working and protection platforms, guardrail systems and access systems in the section headed "Doka Safety Systems".

Stripping lever DF 1.20m

Ausschalhebel DF 1,20m

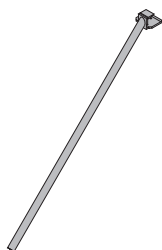
2.7 586158000

Powder-coated yellow