

The Formwork Experts.

# Winch with transport device

Art. n°: 580541000 | 1992 models onward

## Original Operating Instructions

Please retain for future reference

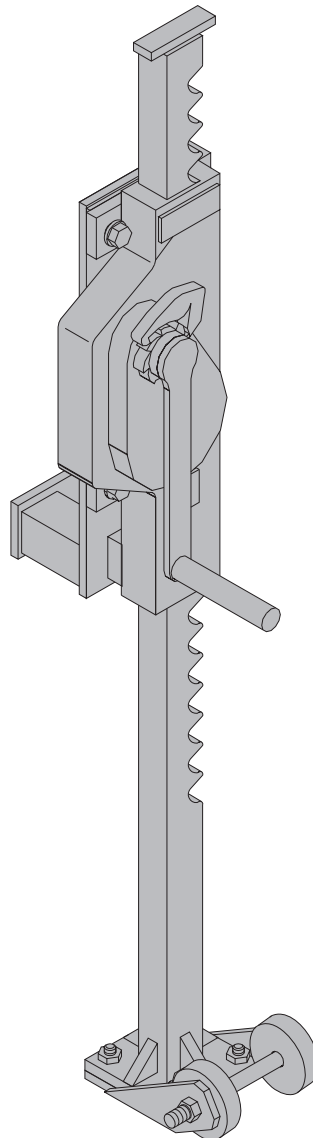

## Basic drawings of product

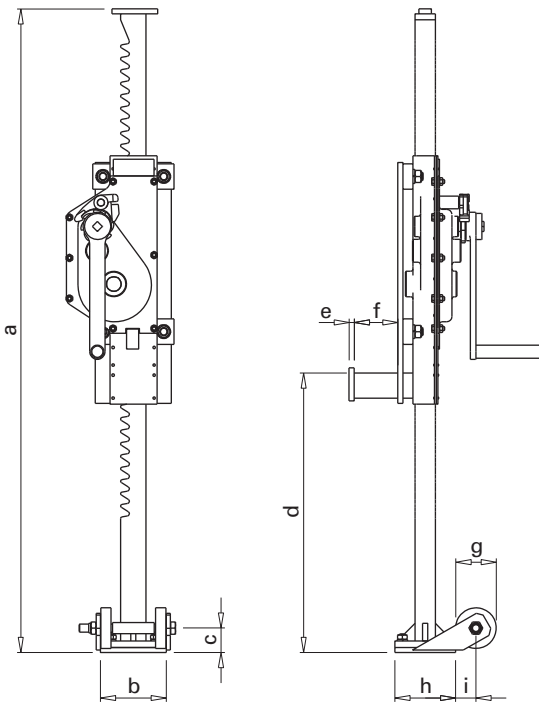

- a ... 1270 mm
- b ... 130 mm
- c ... 48 mm
- d ... min. 130 mm to max. 630 mm
- e ... 10 mm
- f ... 86 mm
- g ... ø80 mm
- h ... 120 mm
- i ... 40 mm

## Intended use

The Winch with transport device is a lifting appliance. It may only be used for mechanical lifting and lowering of Doka supporting construction frames, for making it easier to mount the attachable rollers.

Max. load-bearing capacity: 1400 kg / winch



### Important note:

- It is forbidden to use the product for anything but its designated purpose!
- It is forbidden to lift other manufacturers' formwork with it.

## Maintenance & inspection

- Repairs may only be carried out by the manufacturer!
- Doka accepts no liability for products that have been altered!

### Before every use

- ▶ Check for any signs of damage or visible deformation.



Lifting accessories that do not meet the following criteria must be withdrawn from use immediately:

- Crack-free and notch-free welds.
- No deformation.
- Rating plate must be in place and clearly legible

### At regular intervals

- ▶ Grease the (extended) pinion-rack once a month – more often if subjected to heavy use.
- ▶ Refill the gear reduction unit with new grease once a year.



With the safety crank-handle, make sure that no grease gets onto the brake disc.

- Inspection of lifting accessories must be performed at regular intervals by an **expert** in conformity with **national statutory provisions**. Unless otherwise stipulated, such inspection must be carried out **at least once a year**.

## Storage

- Store lifting accessories in a dry and well ventilated place, protected from the weather and from all corrosive substances.

## Preconditions for use

Where Doka supporting construction frames Universal F are used and no crane assistance is available (e.g. in tunnels), the Attachable rollers 250/200 can be used to provide quick and easy repositioning of the supporting construction frame units.

The Attachable rollers can be attached to the Supporting construction frame Universal F 4.50 m and the Attachable frame F 1.50 m.

Supporting construction frame units to 6.0 m high movable.



### Important note:

The Attachable frame F 2.0 m (supporting construction frame units up to 8.0 m) is not suitable for mounting the Attachable rollers onto.

 **The following points MUST be observed – otherwise you risk the formwork tipping over**

- The floor must be stable, firm and sufficiently smooth (e.g. concrete).
- Keep the travel route clean and free of any obstacles.
- It is forbidden to use any mechanical assistance during the wheeling operation!
- "Passenger transportation" is forbidden.

## Mounting the attachable rollers

 A 'travelling unit' has 2 Attachable rollers 250 (at front, nearest formwork) and 2 Attachable rollers 200 (at rear).

## Safety requirements

- Place a ballast in the rear third of the supporting construction frame unit, to prevent it from tipping over.
  - for wind speeds of up to 50 km/h - ballast weighing 500 kg
  - for wind speeds of up to 70 km/h - ballast weighing 1000 kg

 These data refer to elements of width 2.50 m and height 6.0 m

- Lift the supporting construction frame as far forward (i.e. towards the formwork) as possible, using two winches.
 

If there is any danger of the unit tipping over, the anchor waling must be removed - this enables the winches to be located even further forward.
- Lift the Attachable roller 250 over the front junction point and bolt it into place.
- After lowering the unit, position the winches as far as possible towards the rear, and raise the supporting construction frame unit.
- Bolt the Attachable rollers 200 directly onto the horizontal profiles and secure them with nuts.
- After the supporting construction frame unit has been lowered, it is ready to be wheeled to its next location.

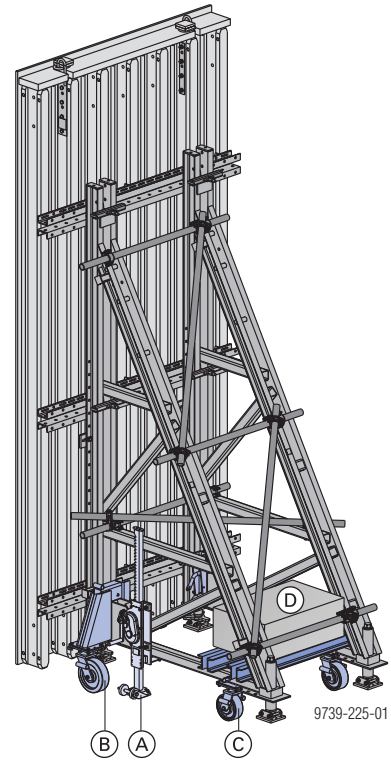

## Cross-section

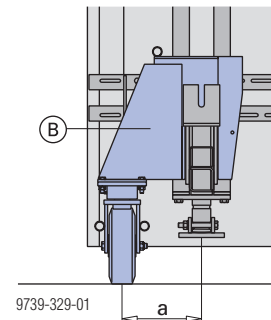

a ... 27 cm

- A** Winch with transport device
- B** Attachable roller 250
- C** Attachable roller 200
- D** Ballast

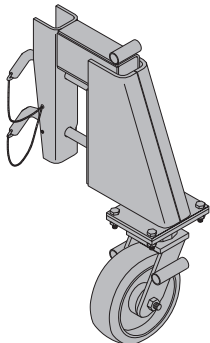
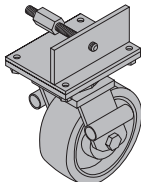
Attachable roller 250	Attachable roller 200
Art. n°. 580537000	Art. n°. 580538000
Max. load: 1400 kg	Max. load: 1000 kg
	



EC Declaration of Conformity  
pursuant to EC Directive 2006/42/EC.

The manufacturer declares that by reason of its conception and design, the following product

**Winch with transport device, Art. n° 580541000**

conforms – in the version marketed by ourselves – to the pertinent fundamental health and safety stipulations of the relevant EC Directives.

**The following harmonised Standards were applied:**

- EN ISO 12100:2010
- EN 349:1993+A1:2008

**Person authorised to compile technical documentation  
(pursuant to European Directive on Machinery Annex II):**

Ing. Johann Peneder  
Josef Umdasch Platz 1  
A-3300 Amstetten

Amstetten, 02.05.2012

Doka GmbH  
Josef Umdasch Platz 1  
A-3300 Amstetten

Ludwig Pekarek,  
Executive Manager

Johann Peneder,  
Authorised Officer, Head of R&D